

T20CB

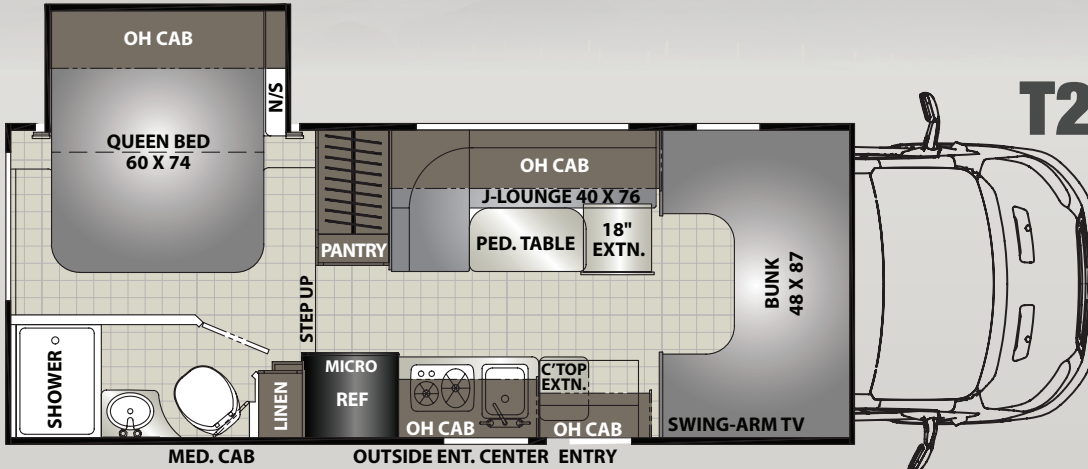

T21RS

SPECIFICATIONS

MODEL	T20CB	T21RS
CHASSIS	Ford Transit T350	Ford Transit T350
ENGINE	V6 3.7L	V6 3.7L
HORSE POWER	275	275
TORQUE	260	260
WHEEL BASE	156"	156"
GVWR* (LBS.)	10,360	10,360
GCWR* (LBS.)	12,125	12,125
CW* (APPROX. LBS.)	8,140	8,140
GAWR FRONT (LBS.)	4,130	4,130
CCC (LBS.)	2,200	2,100
GAWR REAR (LBS.)	7,275	7,275
INTERIOR HEIGHT	6' 9"	6' 9"
EXTERIOR WIDTH	7' 10"	7' 10"
EXTERIOR HEIGHT (W/ A/C)	9' 3"	9' 3"
EXTERIOR LENGTH (W/ HITCH)	23' 9"	23' 9"
HITCH WEIGHT (LBS.)	2,000	2,000
FUEL CAPACITY (GAL.)	25	25
LP CAPACITY (LBS.)	40	40
FRESH WATER CAPACITY (GAL.)	38	38
WATER HEATER CAPACITY (GAL.)	6	6
GREY TANK CAPACITY (GAL.)	28	32
BLACK TANK CAPACITY (GAL.)	26	27
EXTERIOR STORAGE (CU. FT.)	61	35
AWNING LENGTH (FT.)	14'	14'

SEE WHAT'S NEW!

GVWR (Gross Vehicle Weight Rating) is the maximum permissible weight of the unit when fully loaded. It includes all weights, inclusive of all fluids, occupants, cargo, optional equipment and accessories. For safety and product performance do NOT exceed the GVWR.

GCWR (Gross Combined Weight Rating) is the maximum permissible loaded weight of your motor home and any towed trailer or towed vehicle. Actual GCWR of this vehicle may be limited by the sum of the GVWR and the installed hitch receiver maximum capacity rating; see hitch rating label for detail.

GAWR (Gross Axle Weight Rating) is the maximum permissible weight, including cargo, fluids, optional equipment and accessories that can be safely supported by each axle.

* Estimated Average based on standard build optional equipment.

CCC (Cargo Carrying Capacity) ** is the amount of weight available for fresh potable water, cargo, passengers, additional optional equipment and accessories. CCC is equal to GVWR minus UWW. Available CCC should accommodate fresh potable water (8.3 lbs per gallon). Before filling the fresh water tank, empty the black and gray tanks to provide for more cargo capacity.

** Estimated average based on standard build optional equipment

Each Forest River RV is weighed at the manufacturing facility prior to shipping. A label identifying the unloaded vehicle weight of the actual unit and the cargo carrying capacity is applied to every Forest River RV prior to leaving our facilities.

The load capacity of your unit is designated by weight, not by volume, so you cannot necessarily use all available space when loading your unit.

Actual towing capacity is dependent upon your particular loading and towing circumstances, which includes the GVWR, GAWR and GCWR as well as adequate trailer brakes. Please refer to the Operator's Manual of your vehicle for further towing information.



ORION STANDARD FEATURES

INTERIOR EQUIPMENT

- Full Extension Metal Drawer Guides
- Single Child Tether at Forward Facing Dinette
- 34" Curved Grab Handle at Entrance Door
- Residential Size Microwave Oven
- Slim Line Range Hood w/LED Lighting
- Dometic Flush Mount, Double Door Refrigerator
- Easy Clean Glass Refer Panel
- American Stonecast Undermount Kitchen & Bath Sink
- Residential Kitchen Faucet w/Sprayer
- Upgrade Serta Mattress Queen Bed 52 x 80 (20CB)
- Upgrade Williamsburg Flip Mattress 60 x 74 (21RS)
- 110V and 12V/USB Charging Station in Bedroom
- TV Backer and Connections in Bedroom

EXTERIOR EQUIPMENT

- Pre-wired for Satellite Dish
- Slam Latch Trunk Doors
- Outside Shower
- Battery Disconnect
- Heated Holding Tanks
- Rear Ladder
- Color Backup Camera

CONSTRUCTION

- Laminated Aluminum 2" Floor
- Laminated Aluminum 2" Sidewalls
- Crowned, Laminated TPO Roof
- Even Cool A/C Duct System

BANNER PACKAGE (MANDATORY)

EXTERIOR - Side View Cameras, Water Panel With Waste Tank Flush, Carmel Color Infused Fiberglass Sidewalls, Fiberglass Front Wrap, Power Awning, LED Strip Entrance Light, Exterior LED Lights, Solar Ready, Stainless Steel Wheel Liners, Towing Hitch w/4 Way Plug, 4.0 Onan Generator, Exterior Privacy Windshield Cover

INTERIOR - Backup Monitor IPO Rear View Mirror, 24" Coach TV and DVD, Factory AM/FM/CD Radio, Interior LED Lights, Pop-Up Power Tower, Powered Jack Wing Antenna, 13,500 Non-Ducted Low Profile w/Heat Strip A/C, Window Shades, 2 Burner Cooktop, and Travel Easy Roadside Assistance

STAND ALONE OPTIONS

- Cabover Power Vent Fan
- Child Safety Net & Ladder
- 15,000 Low Profile Non-Ducted A/C w/Heat Pump
- Exterior Entertainment Center - 24" TV/Stereo/HDMI Game Port/Speakers
- Aluminum Rims (Mandatory Option on 21RS)



ORION



Coach-Net[®]
RV Technical & Roadside Assistance

YOUR LOCAL DEALER



All information contained in this brochure is believed to be accurate at the time of publication. However, during the model year, it may be necessary to make revisions and Forest River, Inc., reserves the right to make all such changes without notice, including prices, colors, materials, equipment and specifications as well as the addition of new models and the discontinuance of models shown in this brochure. Therefore, please consult with your Forest River, Inc., dealer and confirm the existence of any materials, design or specifications that are material to your purchase decision. 11/16

©Copyright 2016 Coachmen RV a Division of Forest River Inc - All Rights Reserved.

423 N. Main Street • P.O. Box 30
Middlebury, IN 46540

www.coachmenrv.com