

Apex

By Coachmen

Reaching New Heights

Lightweight • Easy To Tow • Contemporary Styling • Rugged Construction!

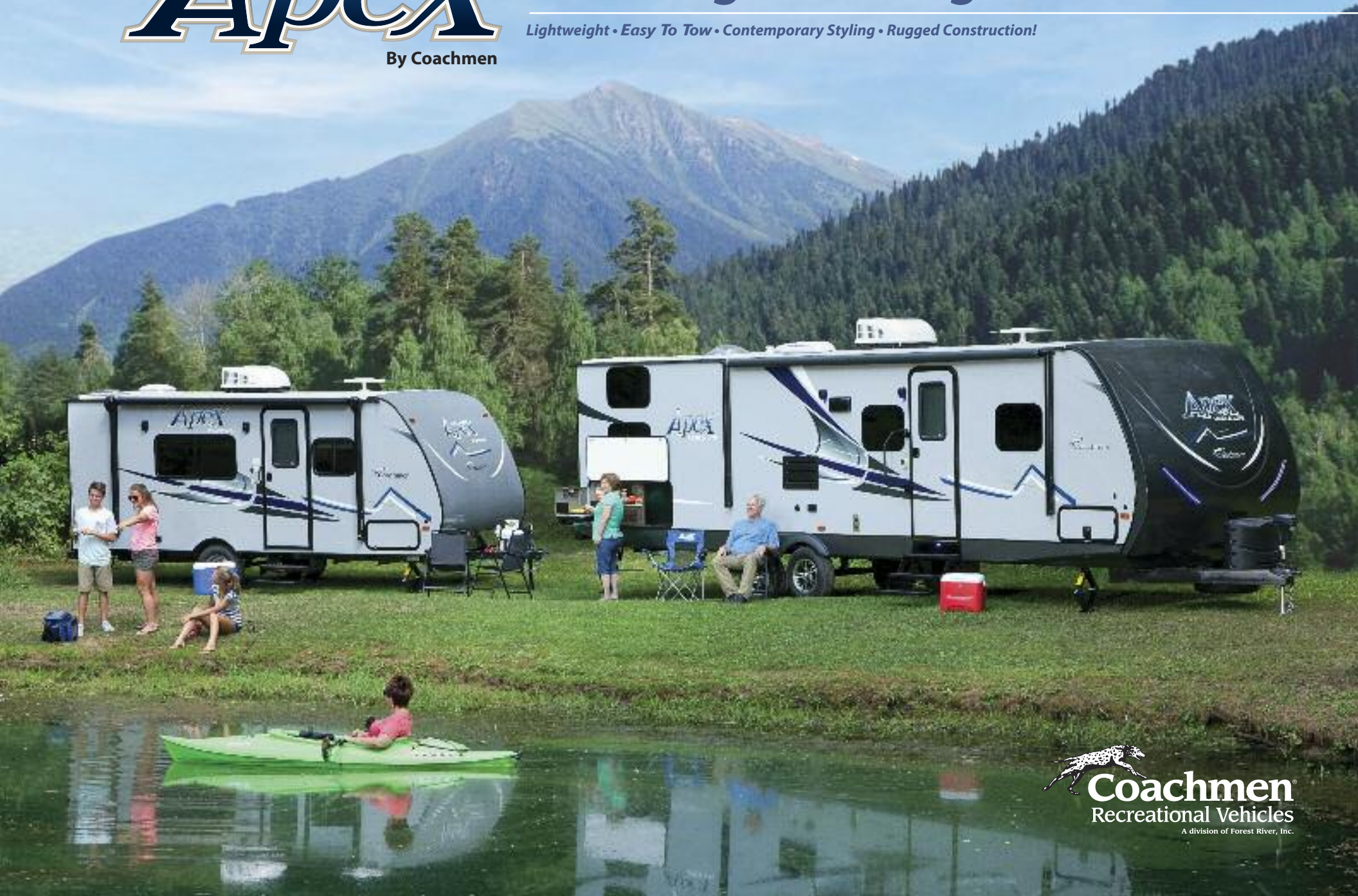

Apex

NANO

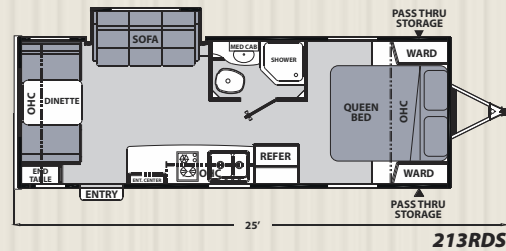
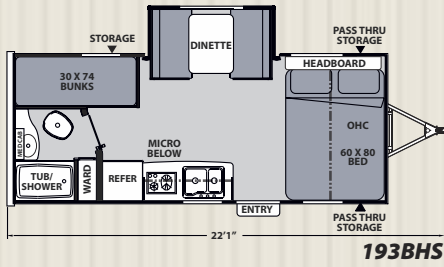
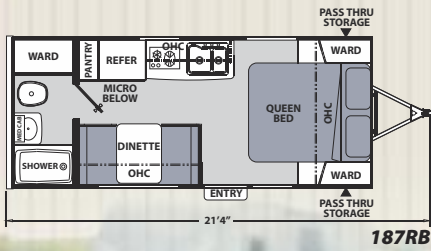
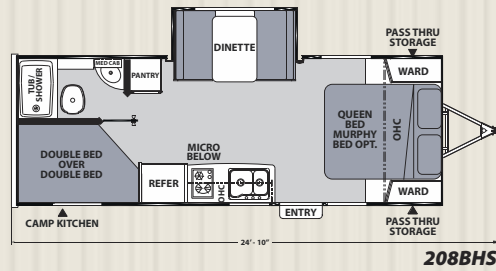
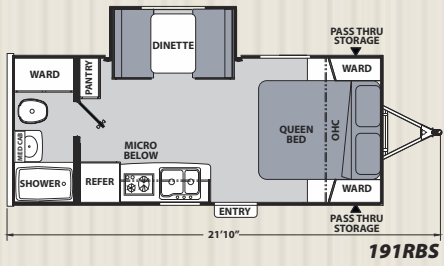
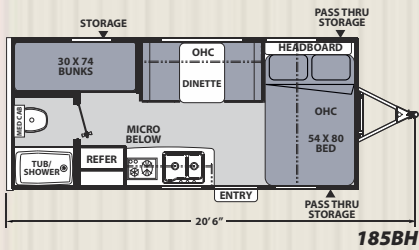
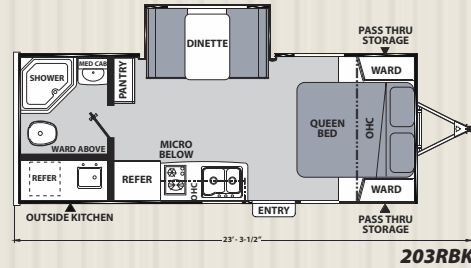
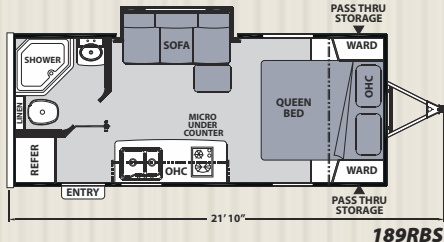
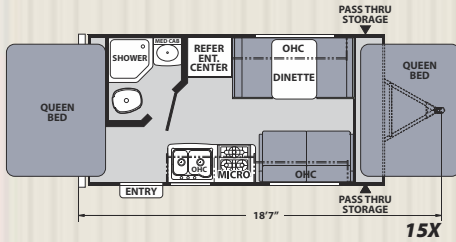

Apex

By Coachmen

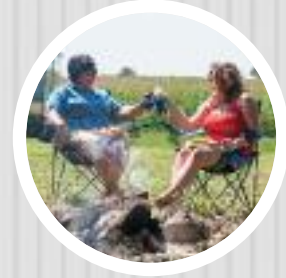

7-1/2 FT. MODELS

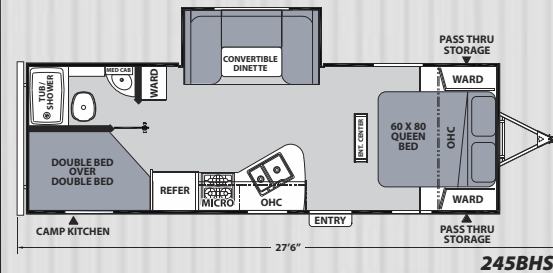
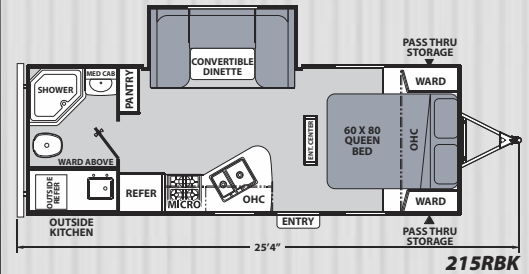

APEX NANO	15X	185BH	187RB	189RBS	191RBS	193BHS	203RBK	208BHS	213RDS
UVW	2920	2850	3034	3453	3335	3370	TBD	TBD	3806
Hitch Weight	360	350	316	418	370	406	TBD	TBD	467
Carrying Capacity	880	950	766	1246	1254	1205	TBD	TBD	2194
GVWR	3800	3800	3800	4700	4700	4700	TBD	TBD	6000
Ext. Length	18'7"	20'6"	21'4"	21'10"	21'10"	22'1"	23'3"	24'10"	25'
Ext. Height w/AC	9'10"	9'7"	9'7"	9'9"	9'9"	9'9"	9'10"	9'10"	9'10"
Fresh Water	30 GAL	30 GAL	30 GAL	30 GAL	30 GAL	30 GAL	30 GAL	30 GAL	30 GAL
Grey Water	30 GAL	30 GAL	30 GAL	30 GAL	30 GAL	30 GAL	30 GAL	30 GAL	30 GAL
Waste Water	30 GAL	30 GAL	30 GAL	30 GAL	30 GAL	30 GAL	30 GAL	30 GAL	30 GAL

See back cover for chart definitions.

APEX	7.5' WIDES		8' WIDES				
	215RBK	245BHS	232RBS	238MBS	249RBS	251RBK	288BHS
UVW	4365	4546	4863	4474	4770	4984	4882
Hitch Weight	446	578	501	563	480	570	585
Carrying Capacity	2135	2003	2137	2026	2230	2016	2118
GVWR	6500	6500	7000	6500	7000	7000	7000
Ext. Length	25'4"	27'6"	26'9"	25'6"	28'3"	28'11"	31'2"
Ext. Height w/AC	10'2"	10'2"	10'8"	10'2"	10'2"	10'2"	10'2"
Fresh Water	30 GAL	30 GAL	50 GAL	50 GAL	50 GAL	50 GAL	50 GAL
Grey Water	30 GAL	30 GAL	35 GAL	35 GAL	35 GAL	35 GAL	35 GAL
Waste Water	30 GAL	30 GAL	35 GAL	35 GAL	35 GAL	35 GAL	35 GAL



8 FT. MODELS

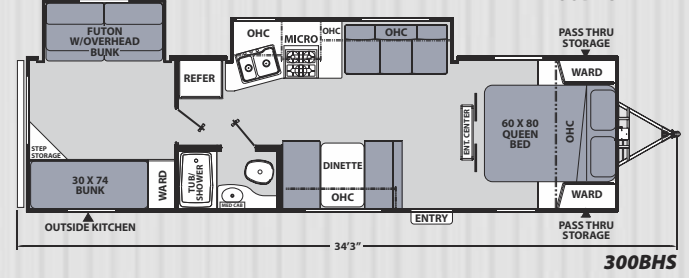
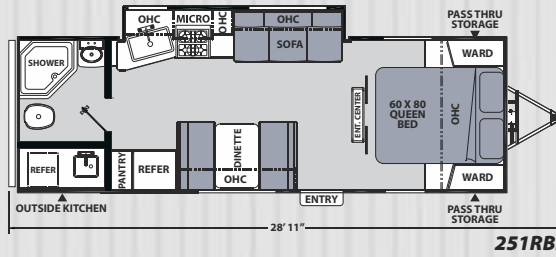
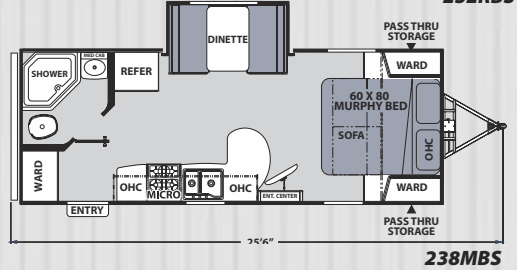
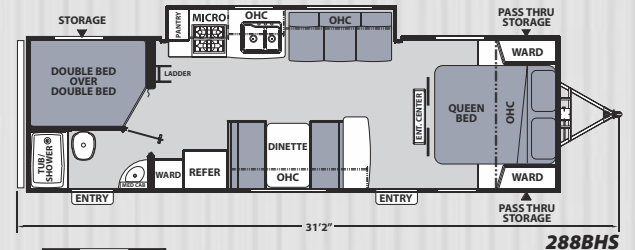
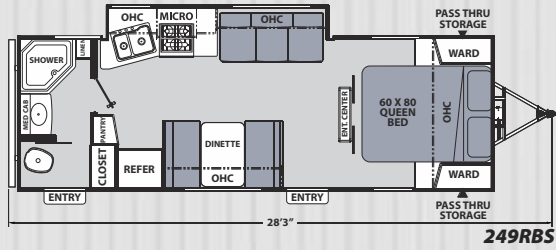
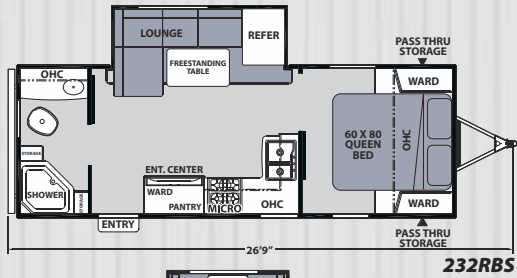

8 FT. DEEP SLIDE MODELS

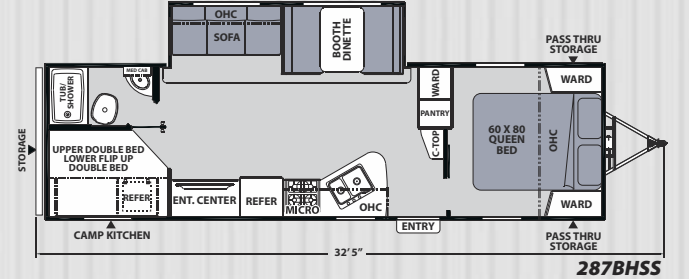
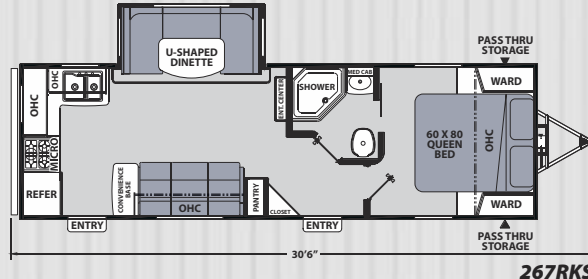
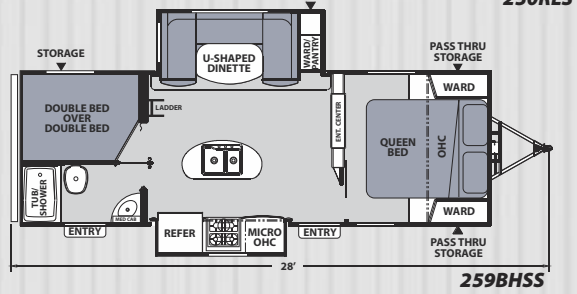
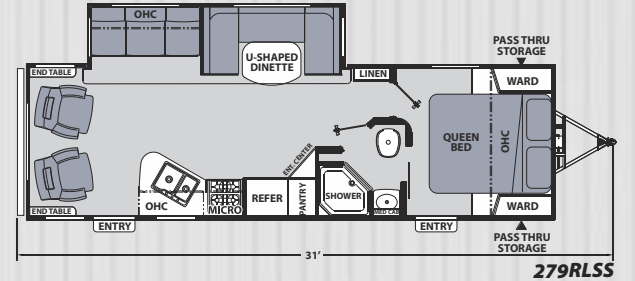
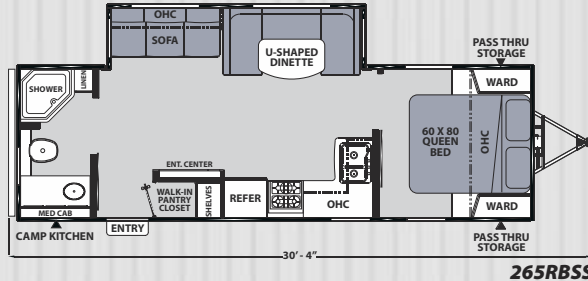
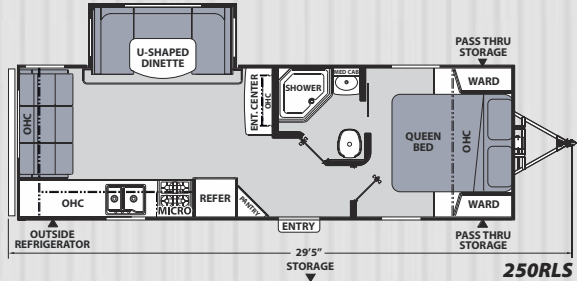

8' WIDE DEEP SLIDES									
300BHS	250RLS	259BHSS	265RBS	267RKS	269RBS	279RLSS	287BHSS	289TBSS	
5977	5210	5370	5652	5415	5590	5490	5946	5720	
672	550	680	734	732	720	620	792	715	
1623	1790	2130	1948	2185	2010	2110	1654	1880	
7600	7000	7500	7600	7600	7600	7600	7600	7600	
34'3"	29'5"	28'	30'4"	30'6"	29'10"	31'	32'5"	32'4"	
10'4"	10'8"	10'8"	10'8"	10'8"	10'8"	10'8"	10'8"	10'8"	
50 GAL	50 GAL	50 GAL	50 GAL	50 GAL	50 GAL	50 GAL	50 GAL	50 GAL	
35 GAL	35 GAL	35 GAL	70 GAL	70 GAL	35 GAL	35 GAL	35 GAL	35 GAL	
35 GAL	35 GAL	35 GAL	35 GAL	35 GAL	35 GAL	35 GAL	35 GAL	35 GAL	

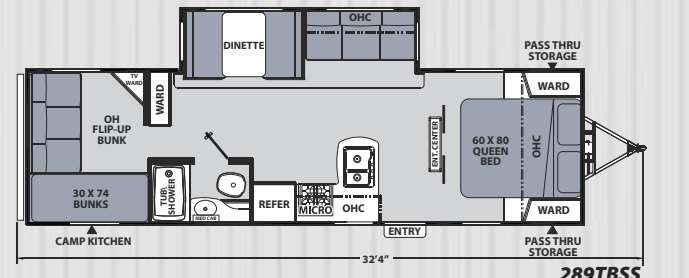
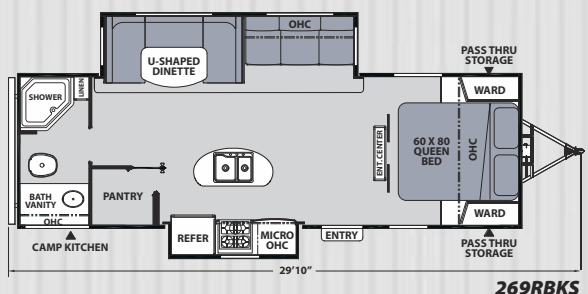



Apex

NANO



Apex Nano is shown with the Summit Package Upgrade Option

Apex Nano Construction

Construction Features

1. 3M breathable graphics
2. Tinted, safety glass windows
3. Welded Aluminum structure, vacuum-bonded sidewalls and roof
4. Dual crowned laminated roof
5. EPDM rubber roofing
6. Azdel Composite Panels (Sidewalls)
7. Aerodynamic front profile
8. 20 lb. LP gas tank
9. Smooth exterior fiberglass skin
10. Aluminum framed openings
11. Fully welded tubular aluminum floor structure
12. Schwintek™ slide system
13. Congoleum flooring
14. Powder E-coated, welded frame
15. Dexter® E-Z Lube® axle
16. Nitrogen filled radial tires



The super-lightweight **Nano 189RBS** is a comfortable home base for memorable family outings in the fresh air! Features include large windows, a double entry step, a 12' power awning and 15" tires.

Nano Standard Features

Interior and Décor

- Ambrosia Ash cabinetry
- Overhead bedroom cabinets
- Congoleum flooring
- Mini-blinds throughout
- Pedestal dinette table
- Large oversized booth
- Hardwood mortise and tenon cabinet door frames
- Residential comforter (Select models)
- Stile and rail cabinet front construction
- 2" Thick insulated floor
- LP leak alarm
- Fire extinguisher
- Smoke alarm
- Carbon monoxide detector

Electrical/Heating/AC

- Outside receptacle GFI
- Detachable marine style power cord

Galley

- Double sink bowl
- One piece seamless countertops
- Brushed nickel hardware

Bath and Water

- Power bath vent
- Water heater bypass valve
- Demand water pump
- Hand-crafted wood medicine cabinet
- Below floor low point drains
- Foot flush toilet
- Separate sink and shower/tub plumbing

Exterior/Construction

- 20# LP tank
- Rubber roof
- Gutter rail
- Dead bolt lock
- Tinted safety glass radius windows
- Radius entrance door with window
- Radius thumb latch baggage doors
- Corrosion resistant powder coated frame
- Dual battery tray
- Break away switch
- Stone guard
- Pass-thru storage
- Double entry step
- Dexter® E-Z Lube® axles
- Nitro filled radial tires



189RBS Shown in Twilight

Nano Package (mandatory)

- Vacuum bonded Azdel fiberglass sidewalls
- Vacuum bonded laminated dual crowned roof/ceiling
- Aluma-cage construction
- Welded aluminum framed floor
- Schwintek slide room system
- Insulated floor with seamless decking
- High efficiency LED interior lighting
- Outside speakers with LED lights (2)
- Stabilizer jacks (4)
- TV antenna with cable hookups
- 6 Gal. DSI water heater
- Outside shower
- Stainless steel microwave
- Double door refrigerator (4.0 cu. ft. single door 15X)
- 2-Burner cooktop
- AM/FM/Bluetooth Stereo
- Skylight in bath
- Evergreen sleep mattress
- Gray exterior fiberglass
- LP port
- Solar prep

Summit Package

- Front cap with integrated window
- Black tank flush
- Magnetic pass-through doors
- Kitchen drawer
- Dinette door

Optional Features

Comfort Package

- 20,000 BTU direct vent furnace
- Power awning with LED lights

Additional Options

- 13.5 BTU roof air conditioner
- Spare tire and carrier





Apex Nanos are the perfect lightweight solution for families on the go. They're easy to tow – and easy to set up for years of fun-filled outdoor adventure.

Apex
NANO

*193BHS Shown in Espresso
with the Summit Package*

Apex

By Coachmen

Perfect for Smaller Tow Vehicles

Pack up, back up, hitch up and go. Apex Ultra Lites are perfect for towing with half ton trucks, minivans and SUVs for fuel efficiency. All Apex floor plans are designed with rich, warm interiors, contemporary cabinetry, fabrics and flooring. Apex travel trailers and hybrid expandables are incredibly lightweight and durable, with fully laminated, aluminum framed sidewalls, floor and roof.

These Ultra Lite Travel Trailers are designed for towing with today's half-ton trucks, minivans and SUVs, with weights ranging from under 3,000 to 6,000 lbs.



267RKS Shown in Twilight



Expand Your Horizons!

TWILIGHT



SHALE



ESPRESSO



Apex super slides have a large, versatile dinette, plenty of windows for natural light and ventilation, and a residential LED dinette light. Shown in Shale.



The comfortable **215RBK** features seamless countertops, a double bowl Stonecast sink, a large dinette, with plenty of windows for natural light. Shown in Espresso.

The **251RBK** has a spacious bathroom with plenty of storage and a large stand up shower with a glass door.





Ultra Lite Travel Trailers are designed for towing by today's half-ton trucks, minivans and SUVs. From 18' to 34' – All units are available under 6,000 lbs.

Standard Features

Interior and Décor

- Ambrosia Ash cabinetry
- Overhead bedroom cabinets
- Sealed edge countertops
- Congoleum flooring
- Mini-blinds – throughout
- Pedestal dinette table
- Large oversized booth with sliding door storage access
- U-shaped dinette with sliding door storage access
- 68" Residential sofa (Most models)
- Energy efficient LED interior lighting
- Hardwood mortise and tenon cabinet door frames
- Stile and rail cabinet front construction
- LP leak alarm
- Fire extinguisher
- Smoke alarm
- Carbon monoxide detector

Electrical/Heating/AC

- Furnace – forced air/ducts per floorplan
- 55 Amp power center
- Outside receptacle GFI
- TV antenna with cable TV hookups
- AM/FM/Bluetooth stereo
- Outside speakers with LED lights (2)
- Ducted air conditioner (8' Wides)
- Detachable marine style power cord

Optional Features

● Apex Elite Package (Mandatory)

- Hard valances with side curtains
- Night shades
- Flush-mount dual sink covers
- AM/FM/CD/DVD/Bluetooth stereo
- 32" LED TV (40" – 265RBSS, 287BHSS)
- USB charging station
- Access doors under dinette
- Swing-away assist handle at main entry
- Ground effects (Metal skirting and ABS fender skirts)
- LED step light

Galley

- Stainless steel microwave
- Stainless steel 3-burner cooktop with oven
- Stainless steel double door refrigerator
- Power LED lighted range hood
- Brushed nickel hardware
- Stonecast double bowl sink

Bath and Water

- Power bath vent
- 6 Gal. gas/elec. DSI hot water heater
- Water heater bypass valve
- Demand water pump
- Medicine cabinet
- Below floor low point drains
- Foot flush toilet
- Tub surround
- Glass shower door – 34" neo-angle showers

Sleeping

- Residential plush comforter
- Evergreen sleep mattress
- Bunk shelves – double over double
- Bedroom vent (28' and up)

Exterior/Construction

- 13.5 Roof A/C
- Power awning with LED lights
- Back-up camera mount
- Spare tire and carrier
- Stabilizer jacks (4)
- LP port

- Double 20# LP tanks
- Solar prep
- Fully laminated aluminum framed radius rubber roof – R-11 (7-1/2' wides), R-14 (8' Wides)
- Vacuum bonded Azdel/fiberglass sidewalls (Additional R-2)
- Laminated aluminum framed fully insulated sidewalls – R-9
- Laminated aluminum framed floor – R-11
- Gutter rail
- Dead bolt lock
- Tinted safety glass radius windows
- Radius entrance door
- Radius thumb latch baggage doors
- I-beam chassis construction
- Corrosion resistant powder coated frame
- Dual battery tray
- Heated/enclosed holding tanks (8' Wides)
- Break away switch
- Schwintek slide room system (N/A Deep slides)
- Pass-thru storage with motion sensor lighting
- Double/triple entry step
- Dexter® E-Z Lube® axles
- Nitro filled radial tires
- Gray exterior sidewalls
- Aztec gray front and rear walls
- Exterior door side cable hook-up
- Aluminum rims

- Slam latch doors at pass thru
- Black tank flush
- Magnetic door catches
- Stone guard
- Hot/cold outside shower
- Bottle covers
- Apex fleece blanket (Sofa models)
- **Summit package**
- Painted fiberglass front cap with LED lighting and spray on stone guard
- Power tongue jack with light
- Backsplash behind stove

Additional Options

- Frameless dark tint windows
- 15,000 BTU roof air conditioner
- Tri-fold Destination Hide-a-Bed sofa (Deep slide models)
- 50 Amp service with second forced A/C (28' and above)



Stonecast Sink (N/A Nano Models)

- Double bowl
- Stain resistant
- Heat resistant up to 500°



LED Interior Lighting

- Energy efficient
- Long lasting



One-Piece Seamless Countertop

- Stain resistant
- Lighter weight
- No T-mold (Helps prevent water damage)



Welded Aluminum Framing (Including front cage)

- All cutouts – compartments, windows, doors and vents
- Lighter weight
- Will not rot

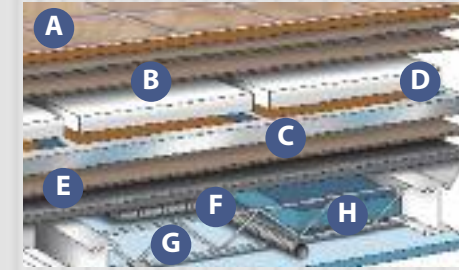

Six Layer Bonded Floor

- A** Residential durable insulated floor covering
- B** Double layer Luan plywood top decking
- C** Welded aluminum frame
- D** Block foam structural insulation
- E** Luan plywood bottom decking
- F** Darco waterproof floor wrap
- G** Cross member support
- H** Holding tanks

Construction Features

- 3M breathable graphics
- Tinted, safety glass windows
- Welded Aluminum structure, vacuum-bonded sidewalls, floor and roof
- Aluminum reinforced laminated roof
- EPDM rubber roofing
- Azdel composite sidewall panels
- Aerodynamic front profile (Shown with painted front cap - Summit Package)
- Dual 20 lb. LP gas tanks
- Insulated slam latch doors with magnetic hold ups (Elite Package)
- Smooth exterior fiberglass skin
- Aluminum framed openings
- Fully enclosed, heated under belly (8' Wide models)
- Fully welded tubular aluminum floor structure
- Schwintek™ and rack and pinion slide systems (Deep slides)
- Congoleum flooring
- Powder E-coated, welded I-beam frame
- Dexter® E-Z Lube® axle hubs
- Nitrogen filled radial tires

Aluminum Reinforced Laminated Roof

- Even insulation that will not deteriorate
- Durable, walk-on roof
- Less weight
- Motorhome type construction

Lightweight Durability!

APEX CONSTRUCTION



Dicor EPDM Rubber Roof: The Durable Choice

- 2-Ply Material
- Superior Tensile Strength
- Puncture and Tear Resistant
- UV Reflective/Refractive
- Requires Less Maintenance
- Does Not Chalk



This convenient camp kitchen keeps cold drinks and hot snacks close by! Available on **208BHS, 245BHS, 265RBSS, 269RBKS, 287BHSS, and 289TBSS.**

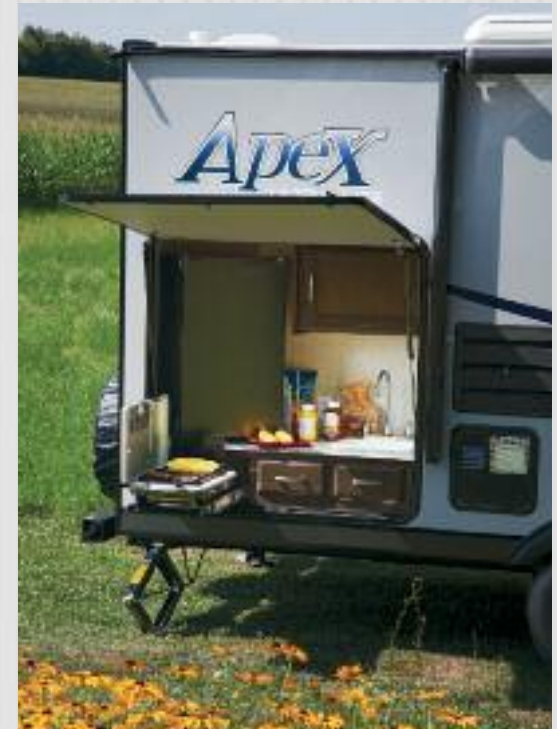

This convenient outside kitchen has a Coleman® grill, large refrigerator, plumbed sink, gooseneck faucet and additional storage for outdoor grilling at its best! It's standard on **203RBK, 215RBK, 251RBK and 300BHS** models.

Lower Center of Gravity for Better Towability

Available Fiberglass Front Cap

- Wrap around design (Better aerodynamics and towability with a high end look)
- Painted not infused
- Spray on stone guard
- LED marker lights

Vacuum Bonded Sidewalls, Roof and Floor

- Stronger construction
- Lighter weight

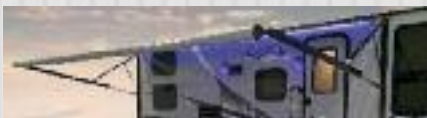

Power Awning

- Available on all APEX models
- Long-lasting LED lights

Apex Is Certified Green TRA Gold Level Rated.

As a Certified Green RV, APEX utilizes effective production techniques in combination with healthy materials, plus efficient usage of energy and water to produce a high quality RV with less environmental impact.



Magnetic Door Closures (Elite Package)

- Holds door up and out of the way while accessing storage

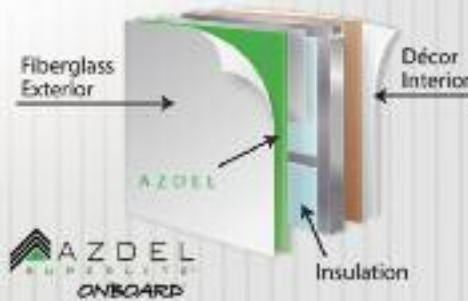

Apex Is Constructed With AZDEL Composite Panels.

AZDEL is 50% lighter than wood, increases insulation value, and won't rot, mold or sustain water damage for years of trouble free camping.



Perfect for Smaller Tow Vehicles



Coachmen Interactive Mobile Manuals

Download your Coachmen mobile app or visit our dynamic online manual to enhance your ownership experience.

These interactive options provide incredible ease and insight into use, maintenance and enjoyment of your Coachmen product. Ranging from "How-To" videos, pictures and illustrations of various components, systems and features to fully searchable content and downloadable PDFs for individual component owner's manuals, answers are always just a click away.



Travel Easy™ Roadside Assistance

RVing is easier with Coachmen's Travel Easy™ Roadside Assistance provided FREE the first year of ownership to those who purchase a New Coachmen RV. Administered by Coach-Net, this service

provides you with 24/7 operational, technical and emergency road service coverage. Also included is towing, fuel delivery, jump starts, lockout service, tire changes, mobile mechanic and unlimited technical assistance. Anywhere. Anytime. Travel Easy™ is the security of knowing that help is an easy phone call away.



CUSTOMER SATISFACTION



www.ForestRiverBuyLocal.com

GVWR (Gross Vehicle Weight Rating) - is the maximum permissible weight of the unit when fully loaded. It includes all weights, inclusive of all fluids, cargo, optional equipment and accessories.

For safety and product performance do NOT exceed the GVWR.

GAWR (Gross Axle Weight Rating) - is the maximum permissible weight, including cargo, fluids, optional equipment and accessories that can be safely supported by a combination of all axles.

UVW (Unloaded Vehicle Weight)* - is the typical weight of the unit as manufactured at the factory. It includes all weight at the unit's axle(s) and tongue or pin and LP Gas. The UVW does not include cargo, fresh potable water, additional optional equipment or dealer installed accessories.

*Estimated Average based on standard build optional equipment.

CCC (Cargo Carrying Capacity)** - is the amount of weight available for fresh potable water, cargo, additional optional equipment and accessories. CCC is equal to GVWR minus UVW.

Available CCC should accommodate fresh potable water (8.3 lbs per gallon). Before filling the fresh water tank, empty the black and gray tanks to provide for more cargo capacity.

**Estimated average based on standard build optional equipment

Each Forest River RV is weighed at the manufacturing facility prior to shipping. A label identifying the unloaded vehicle weight of the actual unit and the cargo carrying capacity is applied to every Forest River RV prior to leaving our facilities.

The load capacity of your unit is designated by weight, not by volume, so you cannot necessarily use all available space when loading your unit.

All information contained in this brochure is believed to be accurate at the time of publication. However, during the model year, it may be necessary to make revisions and Forest River, Inc., reserves the right to make all such changes without notice, including prices, colors, materials, equipment and specifications as well as the addition of new models and the discontinuance of models shown in this brochure. Therefore, please consult with your Forest River dealer and confirm the existence of any materials, design or specifications that are material to your purchase decision.

©2017 Apex by Coachmen RV, a Division of Forest River, Inc., a Berkshire Hathaway company. All rights reserved. 12/17



Learn More

Scan this barcode using a QR Reader on your smart phone to learn more about Forest River.



A Berkshire Hathaway company.



423 N. Main Street ■ P.O. Box 30
Middlebury, IN 46540

To learn more about Coachmen RV and our products and see how Coachmen is making the easy life easier, visit www.coachmenrv.com



Coachmen®
Recreational Vehicles

A division of Forest River, Inc.

Your Apex Dealer