

CATALINA

SBX





291QBCK BACK TO FRONT VIEW



291QBCK EXTERIOR KITCHEN



291QBCK BUNKROOM



Affordable family fun.



251RLS FRONT TO BACK VIEW



251RLS BATHROOM



**Your home on
the road.**



281DDS FRONT TO BACK VIEW

Construction Features

- DIAMOND PLATE ROCK GUARD 1
- FLOOR STUDS 12"-16" ON CENTER 2
- 6 WAY R-7 ECO-BATT INSULATION 3
- CONGOLEUM LINOLEUM 4
- SEWER HOSE STORAGE INTEGRATED INTO THE REAR BUMPER) 5
- 13.5K BTU AIR CONDITIONER 6
- SINGLE PIECE ROOF COVERING 7
- 3/8" ROOF DECKING (FULL WALK-ON) 8
- 5" BOWED TRUSS ROOF RAFTERS 9
- SMOOTH, AERODYNAMIC ALUMINUM FRONT END 10
- .030 ALUMINUM TRIM SKIRT 11
- PLATINUM .024 ALUMINUM SIDING 12
- I-BEAM POWDER-COATED FRAME 13



CATALINA SBX CONSTRUCTION

At Catalina we are proud of the quality that Coachmen has proven for over 52 years. We are committed and excited about continuing that superior level of construction and quality that Coachmen Catalina stands for. We achieve this not only through the use of quality materials, but through our skilled teams that care, focus, and contribute in all stages of our manufacturing process.



WIRELESS REAR VISION CAMERA PREP (CAMERA NOT INCLUDED)



OVERSIZED EXTERIOR BAGGAGE DOOR



RADIUS TRIPLE ENTRY STEP (DOUBLE NON SLIDE MODELS)



2-20 LB. PROPANE TANKS WITH BOTTLE COVER



FOUR (4) STABILIZER JACKS STANDARD ON ALL MODELS (MOST COMPETITORS OFFER THIS AS AN OPTION NOT A STANDARD)



CATALINA'S EXCLUSIVE TIRE AND RIM PACKAGE INCLUDES: RADIAL TIRES, POLISHED ALUMINUM FENDER SKIRTS AND E-COAT MAINTENANCE FREE RIMS

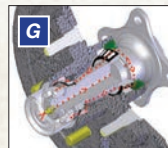

SUPERLUBE™ AXLES FOR FAST AND EASY LUBRICATION



G20 RATED TINTED BLACK FRAMED WINDOWS WITH SAFETY GLASS



5/8" TONGUE IN GROOVE PLYWOOD DECKING GLUED AND STAPLED TO THE FLOOR STUDS- NOT OSB



FULL 6 SIDED R-7 ECO-BATT INSULATION. THIS IS A NEW AND SUSTAINABLE TECHNOLOGY

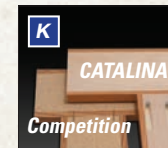

REAL WOOD CABINET STILES THAT ARE SCREWED AND GLUED NOT STAPLED PARTICLE BOARD LIKE THE COMPETITION.

CATALINA SUPERIOR BENEFITS



AIR TIGHT

Seal-Tech Test. We check ALL of our coaches for water leaks by pressurizing the unit and then using a Seal-Tech spray on every part of the unit to identify any problem areas. (We find the problem areas, so you don't have to.)



CABINETRY

All of our craftsman are thoroughly trained to use a framing table with jigs and clamps. This ensures that the cabinets are built to extremely tight tolerances for tight and secure cabinetry that will last for years. This method requires real wood styles, not MDF.



ELECTRICAL TESTING

A thorough electrical check makes sure that all electrical components are in working order, and that no electrical connections have been compromised during construction.



FLOORING

The floor is the base and key component of your RV. Therefore, we refuse to build anything but the best. Beginning with building the frame on 12"-16" centers, and bolting as well as gluing the 5/8" tongue and groove plywood, our methods and materials set us apart from the competition.



COUNTERTOPS

Drop edge Thermofoil countertop Benefits: Pull Test - it pulls at 450-500 PSI, it will pull the core apart before the Thermofoil gives. Cold Cracks - will not cold crack or pull out like a T-mold Edge or Self-Edge. Moisture Exposure - it will withstand moisture better than T-mold Edge or Self-Edge because it is sealed so that no water can penetrate.



SAFETY

A pressurized LP line test ensures that your unit is safe and all LP gas components are in working order.

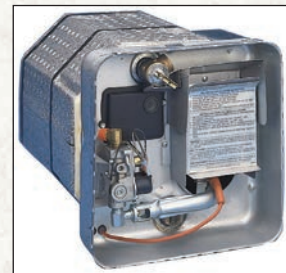

HOT WATER

Our standard 6 gallon gas/electric DSI water heater allows you to fire up your water heater quickly and easily from inside your Catalina. It also features a great quick recovery feature which allows you to heat up to 16.2 gallons of hot water per hour. So whether you are washing the dishes or taking a shower, you'll always have plenty of hot water.



SUPERIOR AIR FLOW

Our full radius smooth metal front end creates a more aerodynamic unit providing:

- BETTER AIRFLOW
- IMPROVED FUEL COSTS
- BETTER TOWABILITY
- EASY TO CLEAN

FREE SBX Edition Package

FREE



A

FREE



B

FREE



C

FREE



D

FREE



E

FREE



F

- A 13,500 BTU DUCTED A/C
- B POWER AWNING WITH LED LIGHT
- C 6 GALLON G/E DSI WATER HEATER
- D SKYLIGHT ABOVE TUB/SHOWER
- E PLEATED NIGHT SHADES IN LIVING ROOM
- F BLUETOOTH STEREO W/CD,DVD, MP3, SD, USB AND AM/FM RADIO
- G UNDER MOUNT DUAL BASIN DEEP KITCHEN SINK
- H STAB JACKS (4)
- I LIGHTED VENT HOOD
- J 3 BURNER RANGE WITH OVEN
- K LED INTERIOR LIGHTING
- L DIGITAL MICROWAVE
- M REAR VISION CAMERA PREP
- N SPARE TIRE AND COVER
- O SPORT WHEEL PACKAGE (SILVER E-COAT SPORT WHEELS WITH CHROME HUBS AND LUGS)
- P FRONT DIAMOND PLATE AND 2-20 LB. PROPANE TANKS WITH BOTTLE COVER
- Q BLACK TANK FLUSH
- R OUTSIDE MARINE GRADE SPEAKERS (2)

FREE



G

FREE



H

FREE



I

FREE



J

FREE



K

FREE



L

FREE



M

FREE



N

FREE



O

FREE



P

FREE



Q

FREE



R

FREE SBX EDITION PACKAGE

Catalina would like to reward our outstanding Dealers and Customers for their continued business! There is no better way to reward you than with the SBX Edition Package! All of our best options have been combined into a FREE SBX Edition Package. At Coachmen Catalina, we overtly express our gratitude to those who have already become a part of the Coachmen Family and warmly welcome those future campers that choose Coachmen Products. Thank you for your business!

STANDARDS AND OPTIONAL FEATURES

STANDARD EXTERIOR FEATURES

- Cambered structural steel I-Beam frame with full width out riggers)
- 3/8" Fully decked walk-on roof
- One-piece seamless roof membrane
- Radius entry steps
- 5/8" Tongue & groove plywood floor decking
- R-7 fiberglass insulation in sidewalls, roof and floor
- G-20 tinted windows
- Rain gutters with extended molded downspouts
- Platinum .024" Aluminum exterior skin with .030 skirt metal
- Painted bumper with drain hose carrier and end caps
- Radius-cornered fiberglass entrance door
- Roto-cast holding tanks
- Flush mount baggage doors that are lockable and radius cornered
- Polished aluminum fender skirts
- Self-adjusting brakes
- 110V G.F.C.I. protected exterior receptacle
- 30-Amp electrical service with deluxe 110v 45-Amp power converter
- City water hook-up
- Full size camp kitchen (301BHS CK, 321BHDS CK)
- Pull out camp kitchen (291QBCK)
- Frame mounts/prep for cargo/bike rack receiver tube

STANDARD INTERIOR FEATURES

- Screwed cabinet construction with pocket bored solid lumber core stiles
- Grace Cherry stained wood cabinets
- Swing arm TV bracket
- Congoleum wood plank linoleum flooring
- 35K BTU auto-ignition furnace with wall thermostat
- 12V demand water pump
- Systems monitor panel
- Radius corner interior walls (where applicable)
- Residential in-floor ducted heat
- 81" Living room ceiling height (78" 231RB, 261BH)
- Cable/TV hook-up in front bedroom
- Solid master bedroom doors (optional on 231RB, 261BH)
- Under-bed storage
- 2 Shirt closets with mirrors
- Night stands with receipts
- Decorative glass in living room cabinets
- Jack knife convertible sofa with pillows
- Hard valance window treatment
- Drop edge Thermofoil countertop
- Gas/Electric double door refer with reversible insert
- Residential high rise faucet
- Easy-View extra large picture window at dinette
- Silverware drawer
- Large dinette tabletop with marine grade pedestal
- Shower curtain with curved track

- ABS tub and shower surround
- Radius shower with glass doors (231RB, 251RLS, 261RKS, 281RKS)
- Marine toilet with foot flush
- Full size medicine cabinet w/ mirror

FOR YOUR SAFETY

- Smoke alarm
- Fire extinguisher
- Dead-bolt lock on entry door
- LP/CO2 gas detector
- Fire escape windows

POPULAR OPTIONS

- Heated and enclosed underbelly (N/A 231RB, 261BH)
- 15K BTU ducted A/C IPO 13.5K BTU A/C
- Bed comforter
- 3 Decor options Mocha, Peppercorn, Biscotti
- 50 amp service WITH 2nd A/C prep (321BHDS CK only)
- 30 Lb. LP Bottles with cover
- Two (2) Sink Covers
- Full wall w/pocket door and wall mirror (231RB, 261BH)
- Pull out camp kitchen (261BHS only)

FREE

SBX EDITION PACKAGE

- 13,500 BTU DUCTED A/C
- POWER AWNING WITH LED LIGHT
- 6 GALLON G/E DSI WATER HEATER
- SKYLIGHT ABOVE TUB/SHOWER
- PLEATED NIGHT SHADES IN LIVING ROOM
- BLUETOOTH STEREO W/ CD, DVD, MP3, SD, USB AND AM/FM RADIO
- UNDER MOUNT DUAL BASIN DEEP KITCHEN SINK
- STAB JACKS (4)
- LIGHTED VENT HOOD
- 3 BURNER RANGE WITH OVEN
- LED INTERIOR LIGHTING
- DIGITAL MICROWAVE
- REAR VISION CAMERA PREP
- SPARE TIRE AND COVER
- 2-20 LB. PROPANE TANKS WITH BOTTLE COVER
- FRONT DIAMOND PLATE ROCK GUARD
- BLACK TANK FLUSH
- OUTSIDE MARINE GRADE SPEAKERS (2)
- SPORT WHEEL PACKAGE (SILVER E-COAT SPORT WHEELS WITH CHROME HUBS AND LUGS)



Floorplans

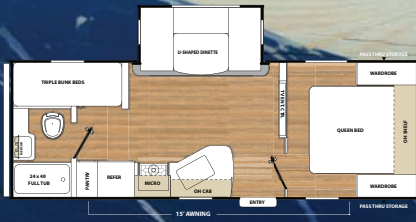

221TBS

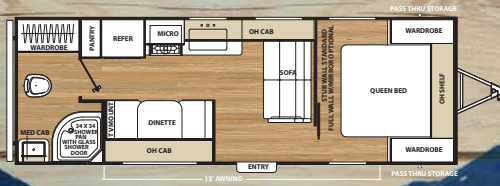

231RB

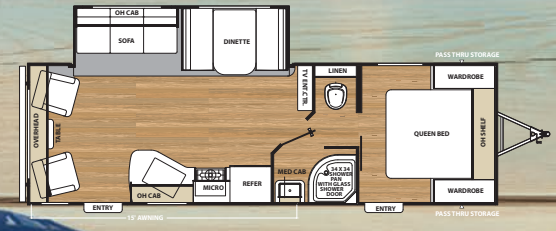

251RLS

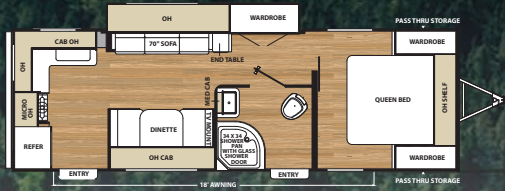

261RKS

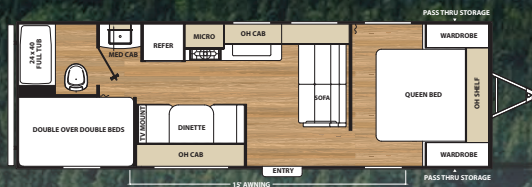

261BH

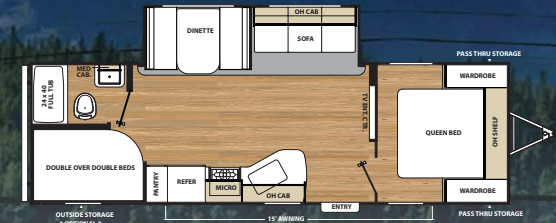

261BHS

REFER
MICRO
OH CAB

PULL OUT CAMPER BITCHEN WITH REFER, COLEMAN COOKING GRILL, AND SINK.

Customer Notes



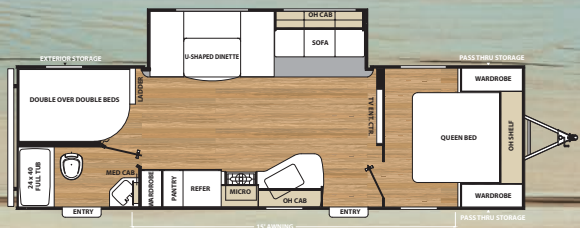

281DDS

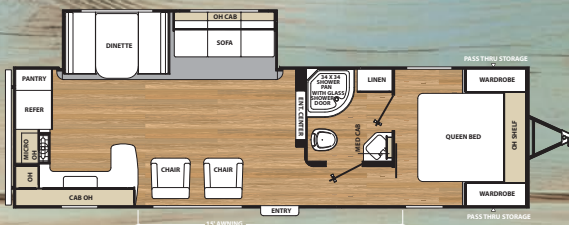

281RKS

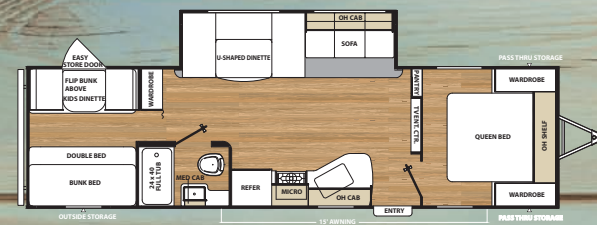

291QBS

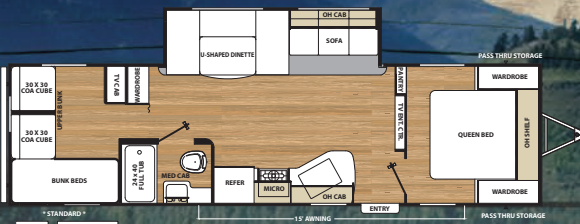

291QBCK

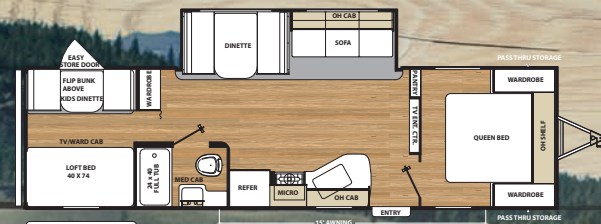

301BHS CK

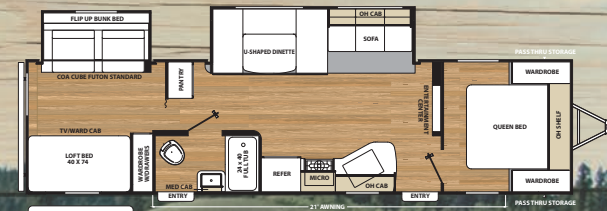

321BHDS CK

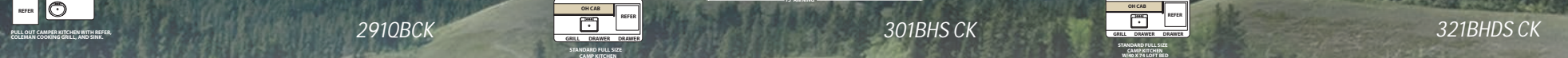

MODEL	221TBS	231RB	251RLS	261BH	261BHS	261RKS	281DDS	281RKS	291QBCK	291QBS	301BHS CK	321BHDS CK
UVW	5,273	4,556	6,112	4,748	6,198	5,502	6,169	6,681	6,528	6,553	6,656	7,750
Carrying Capacity	2,227	2,444	1,558	2,252	1,502	1,998	1,431	2,519	2,972	2,447	2,344	1,750
GVWR	7,500	7,000	7,700	7,000	7,700	7,500	7,600	9,200	9,500	9,000	9,000	9,500
Hitch Weight	710	552	718	541	738	690	688	703	940	850	710	790
Exterior Height (with A/C)	10'7"	10'7"	11'1"	10'7"	11'1"	10'7"	11'1"	11'1"	11'1"	11'1"	11'1"	11'1"
Fresh Water Capacity (gal.)	46	46	46	46	46	46	46	46	46	46	46	46
Grey Water Capacity (gal.)	40	40	70	40	40	40	40	70	40	40	70	70
Waste Water Capacity (gal.)	30	30	30	30	30	30	30	30	30	30	30	30
Awning Length	15'	15'	15'	15'	15'	18'	15'	15'	18'	15'	15'	21'
Wheel Size	14"	14"	15"	14"	15"	14"	15"	15"	15"	15"	15"	15"
Exterior Length	26'9"	27'5"	29'10"	29'3"	30'3"	28'4"	31'7"	32'6"	33'5"	33'5"	33'5"	35'10"
Exterior Width	96"	96"	96"	96"	96"	96"	96"	96"	96"	96"	96"	96"
Interior Height	81"	81"	81"	81"	81"	81"	81"	81"	81"	81"	81"	81"
Axles	3500 LBS	3500 LBS	3500 LBS	3500 LBS	3500 LBS	3500 LBS	3500 LBS	4400 LBS	4400 LBS	4400 LBS	4400 LBS	4400 LBS



COA

COACHMEN OWNERS ASSOCIATION

FREE MEMBERSHIP

www.coachmenowners.com

CUSTOMER SATISFACTION



www.ForestRiverBuyLocal.com



Travel Easy™ Roadside Assistance

RVing is easier with Coachmen's Travel Easy™ Roadside Assistance provided FREE the first year of ownership to those who purchase a New Coachmen RV. Administered by Coach-Net, this service provides you with 24/7 operational, technical and emergency road service coverage. Also included is towing, fuel delivery, jump starts, lockout service, tire changes, mobile mechanic and unlimited technical assistance. Anywhere. Anytime. Travel Easy™ is the security of knowing that help is an easy phone call away.

All information contained in this brochure is believed to be accurate at the time of publication. However, during the model year, it may be necessary to make revisions and Forest River, Inc., reserves the right to make all such changes without notice, including prices, colors, materials, equipment and specifications as well as the addition of new models and the discontinuance of models shown in this brochure. Therefore, please consult with your Forest River dealer and confirm the existence of any materials, design or specifications that are material to your purchase decision.

To learn more about Coachmen RV and our products and see how Coachmen is leading the great outdoors, visit www.coachmenrv.com
Coachmen Industries 423 N. Main St., Middlebury, IN 46540
Phone: 574-825-5821

GVWR (Gross Vehicle Weight Rating) - is the maximum permissible weight of the unit when fully loaded. It includes all weights, inclusive of all fluids, cargo, optional equipment and accessories. For safety and product performance do NOT exceed the GVWR.

GAWR (Gross Axle Weight Rating) - is the maximum permissible weight, including cargo, fluids, optional equipment and accessories that can be safely supported by a combination of all axles.

UVW (Unloaded Vehicle Weight)* - is the typical weight of the unit as manufactured at the factory. It includes all weight at the unit's axle(s) and tongue or pin and LP Gas. The UVW does not include cargo, fresh potable water, additional optional equipment or dealer installed accessories.

*Estimated Average based on standard build optional equipment.

CCC (Cargo Carrying Capacity)** - is the amount of weight available for fresh potable water, cargo, additional optional equipment and accessories. CCC is equal to GVWR minus UVW. Available CCC should accommodate fresh potable water (8.3 lbs per gallon). Before filling the fresh water tank, empty the black and gray tanks to provide for more cargo capacity.

** Estimated average based on standard build optional equipment

Each Forest River RV is weighed at the manufacturing facility prior to shipping. A label identifying the unloaded vehicle weight of the actual unit and the cargo carrying capacity is applied to every Forest River RV prior to leaving our facilities. The load capacity of your unit is designated by weight, not by volume, so you cannot necessarily use all available space when loading your unit.

CATALINA

SBX



Learn More
Scan this barcode using a QR Reader on your smart phone to learn more about Forest River.



A Berkshire Hathaway company.



YOUR CATALINA SBX DEALER



© Copyright 2017 Catalina, Coachmen RV, a Division of Forest River Inc., A Berkshire Hathaway company. All Rights Reserved