

# FREEDOM Express

**SELECT**



**29 SE**

Freedom Express has combined our most popular features and floorplans to create a selection of value added models. They come complete with private master bedrooms, seamless kitchen counters, entertainment towers, and our signature Freedom Express vacuum bonded Azdel sidewall construction.

SELECT ULTRA LITE TRAVEL TRAILERS



#### Select Value Package (Required):

- Radial Tires with Silver Steel Wheels
- Spare Tire
- Detachable Power Cord
- Electric Power Awning
- Solar Port
- Tinted Safety Glass Windows
- Front Diamond Plate
- TV and Radio Antenna with Booster
- E-Z Lube® Axles
- Heated/Enclosed Underbelly
- 33/33 Gal. Grey, Black Holding Tank
- 49 Gal. Fresh Water Tank
- Two Exterior Speakers
- AM/FM/Bluetooth Receiver
- Two Exterior, Two Interior Speakers
- Ducted Ceiling A/C\*\*
- Ducted Furnace\*\*
- 6 Gal. DSI Gas/Electric Water Heater
- LED Interior Lighting
- Mortise and Tenon Cabinet Door
- Congoleum Diamond Flooring
- Night Shades
- Microwave
- Oven with 3-Burner Cooktop\*
- 6 Cu. Ft. Two-door Refrigerator
- Silverware Drawer
- Double Basin Sink
- Bath Skylight
- 60" x 80" Queen Bed\*
- Two-tone Bedspread
- Back-up Camera Prep
- RVIA Seal

#### Additional Options

- Leisure Package - 32" TV, Power Tongue Jack, LED Awning Light
- 15,000 BTU Roof Air Conditioner
- 50 Amp Service with Second A/C Prep
- Canadian Compliance

\*Not Available on 17BLSE \*\*Select Models Only

The 29 SE, shown in Acorn décor, is packed with familiar Freedom Express features and has plenty of room with four bunks, a King U-Dinette, great counter space and storage for the short or extended excursion.



FREEDOM TO EXPLORE

# FREEDOM

## SELECT Express

SELECT ULTRA LITE TRAVEL TRAILERS

### DECOR



ACORN



- 50% Lighter than wood
- No rot, mold or water damage
- R-2 thermal insulation
- Odorless, no formaldehyde
- Sound and energy absorbing
- Impact and puncture resistant
- Made in USA

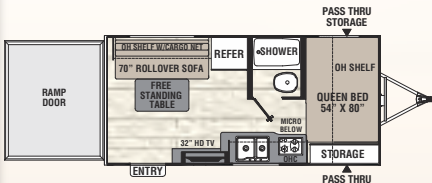

17 BL SE / Exterior Length 20' 4"

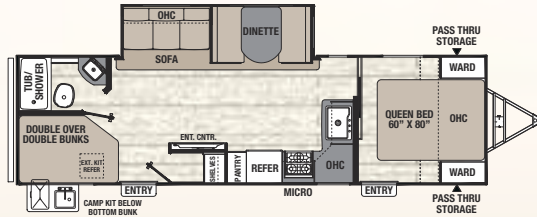

28.7 SE / Exterior Length 32' 11"

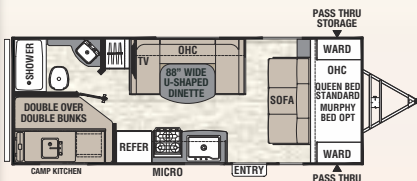

23.9 SE / Exterior Length 25' 10"

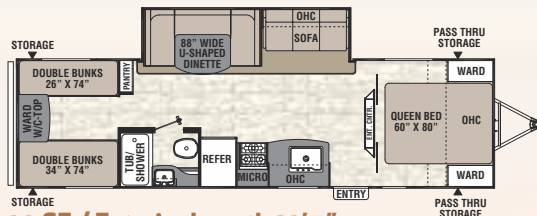

29 SE / Exterior Length 33' 5"

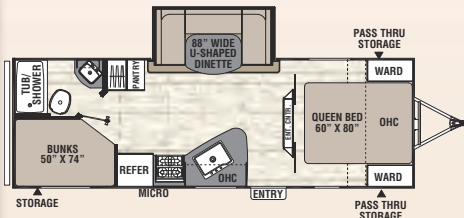

25 SE / Exterior Length 28' 7"

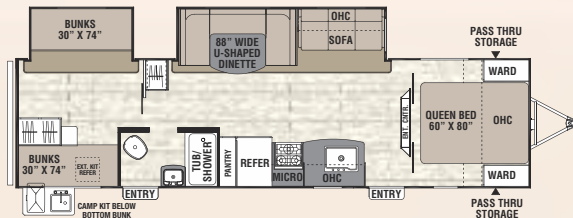

31 SE / Exterior Length 35' 7"

Freedom Express Special Editions	17BL SE	23.9 SE	25 SE	28.7 SE	29 SE	31 SE
UVW*	3,596	4,572	4,980	6,100	5,638	6,766
Hitch Weight	508	566	555	720	639	704
Carrying Capacity	2,304	2,428	2,520	1,600	1,962	2,734
Exterior Length	20' 4"	25' 10"	28' 7"	32' 11"	33' 5"	35' 7"
Exterior Height	10' 3"	10' 4"	10' 9"	10' 9"	10' 9"	11'
Interior Height	81"	81"	81"	81"	81"	81"
Awning Length	12'	16'	20'	18'	16'	16'
Fresh/Grey/Waste Water Capacity (gal.)	49/33/33	49/33/33	49/33/33	49/66/33	49/33/33	49/33/33
Tire Size	ST205/75R14D	ST205/75R14D	ST205/75R14D	ST205/75R14D	ST205/75R14D	ST225/75R15E

\*Unloaded vehicle weights do not include options. See below for definitions of chart descriptions.



423 N. Main Street ■ P.O. Box 30 ■ Middlebury, IN 46540

To learn more about Coachmen RV and our products and see how Coachmen is making the easy life easier, visit [www.coachmenrv.com](http://www.coachmenrv.com) or call 1.800.353.7383.



[www.ForestRiverBuyLocal.com](http://www.ForestRiverBuyLocal.com)

Your Freedom Express Dealer

GVWR (Gross Vehicle Weight Rating) - is the maximum permissible weight of the unit when fully loaded. It includes all weights, inclusive of all fluids, cargo, optional equipment and accessories. For safety and product performance do NOT exceed the GVWR.

GAWR (Gross Axle Weight Rating) - is the maximum permissible weight, including cargo, fluids, optional equipment and accessories that can be safely supported by a combination of all axes.

UVW (Unloaded Vehicle Weight)\* - is the typical weight of the unit as manufactured at the factory. It includes all weight at the unit's axle(s) and tongue or pin and LP Gas. The UVW does not include cargo, fresh potable water, additional optional equipment or dealer installed accessories.

\*Estimated Average based on standard build optional equipment.

CCC (Cargo Carrying Capacity)\*\* - is the amount of weight available for fresh potable water, cargo, additional optional equipment and accessories. CCC is equal to GVWR minus UVW. Available CCC should accommodate fresh potable water (8.3 lbs per gallon). Before filling the fresh water tank, empty the black and gray tanks to provide for more cargo capacity.

\*\* Estimated average based on standard build optional equipment

Each Forest River RV is weighed at the manufacturing facility prior to shipping. A label identifying the unloaded vehicle weight of the actual unit and the cargo carrying capacity is applied to every Forest River RV prior to leaving our facilities.

The load capacity of your unit is designated by weight, not by volume, so you cannot necessarily use all available space when loading your unit.

All information contained in this brochure is believed to be accurate at the time of publication. However, during the model year, it may be necessary to make revisions and Forest River, Inc. reserves the right to make all such changes without notice, including prices, colors, materials, equipment and specifications as well as the addition of new models and the discontinuance of models shown in this brochure. Therefore, please consult with your Forest River dealer and confirm the existence of any materials, design or specifications that are material to your purchase decision.

©2018 Freedom Express by Coachmen, a Division of Forest River, Inc., a Berkshire Hathaway company. All Rights Reserved. 11/18



Learn More  
Scan this barcode using a QR Reader on your smart phone to learn more about Forest River.

