

APEX

By Coachmen

REACHING NEW HEIGHTS



7-1/2' WIDE

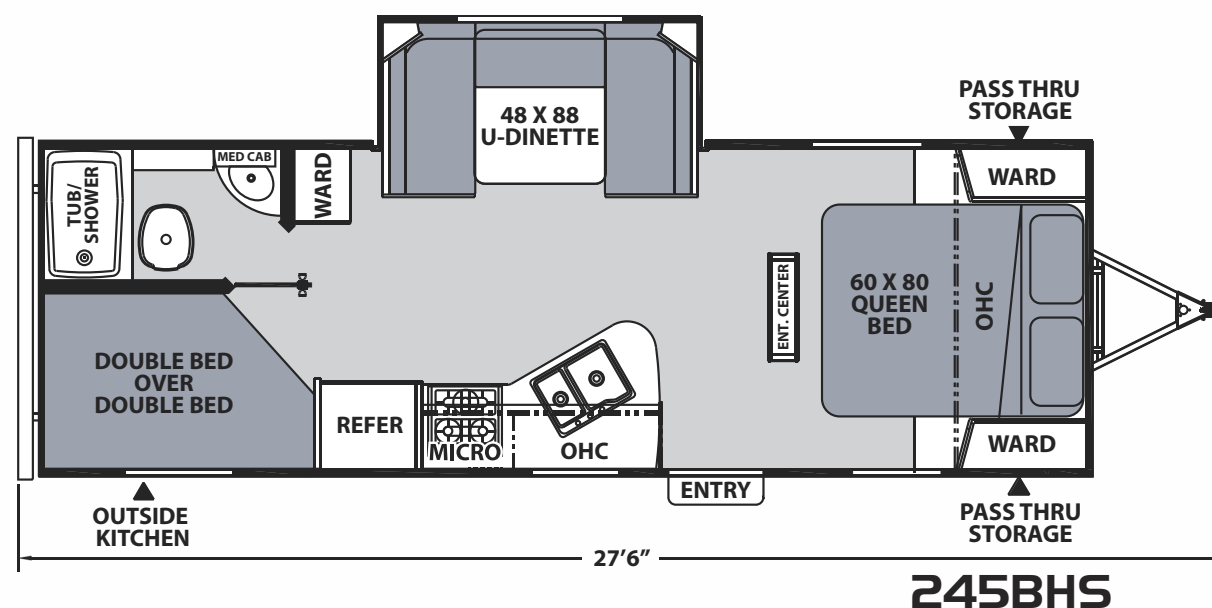
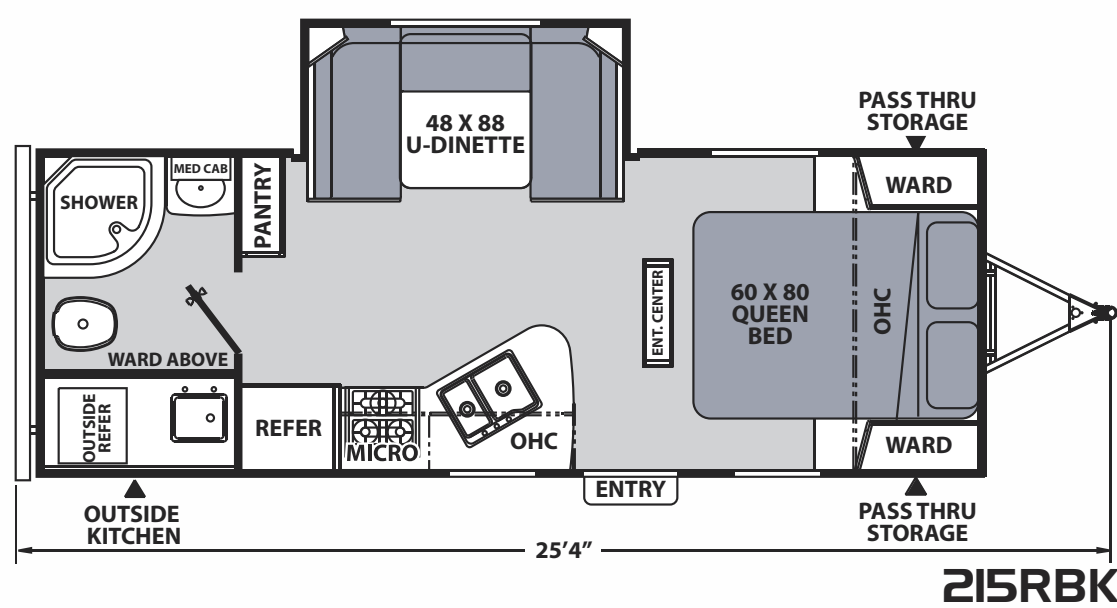

AZDEL composite panels are 50% lighter than wood, increase insulation value, and won't rot, mold or sustain water damage for years of trouble free camping.

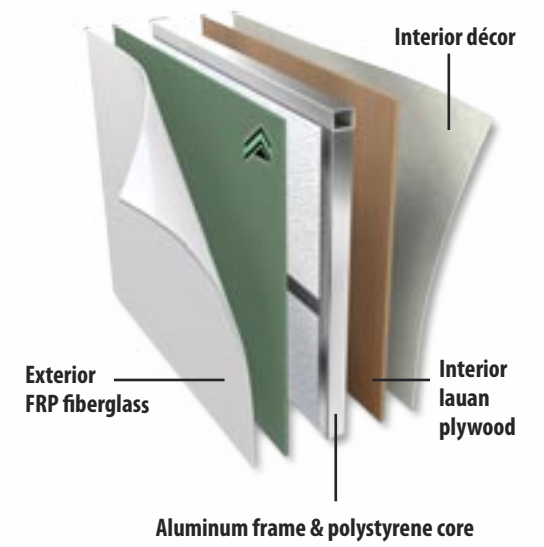

8' WIDE

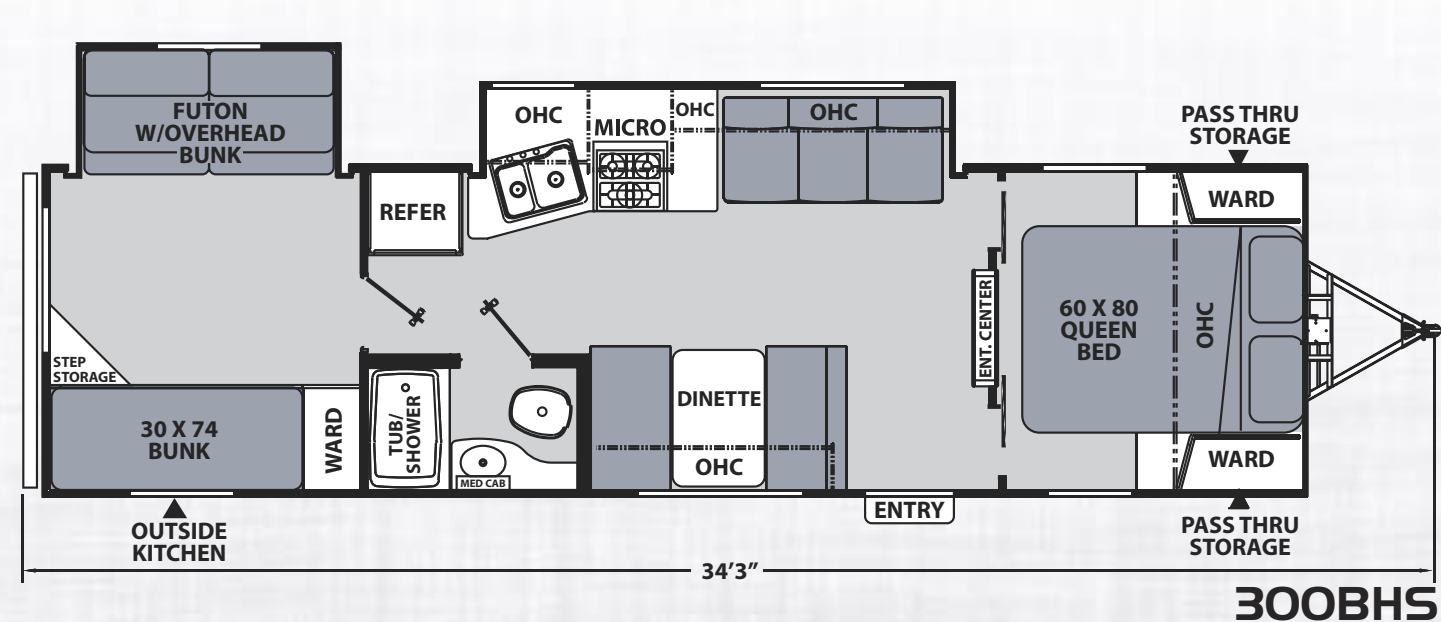
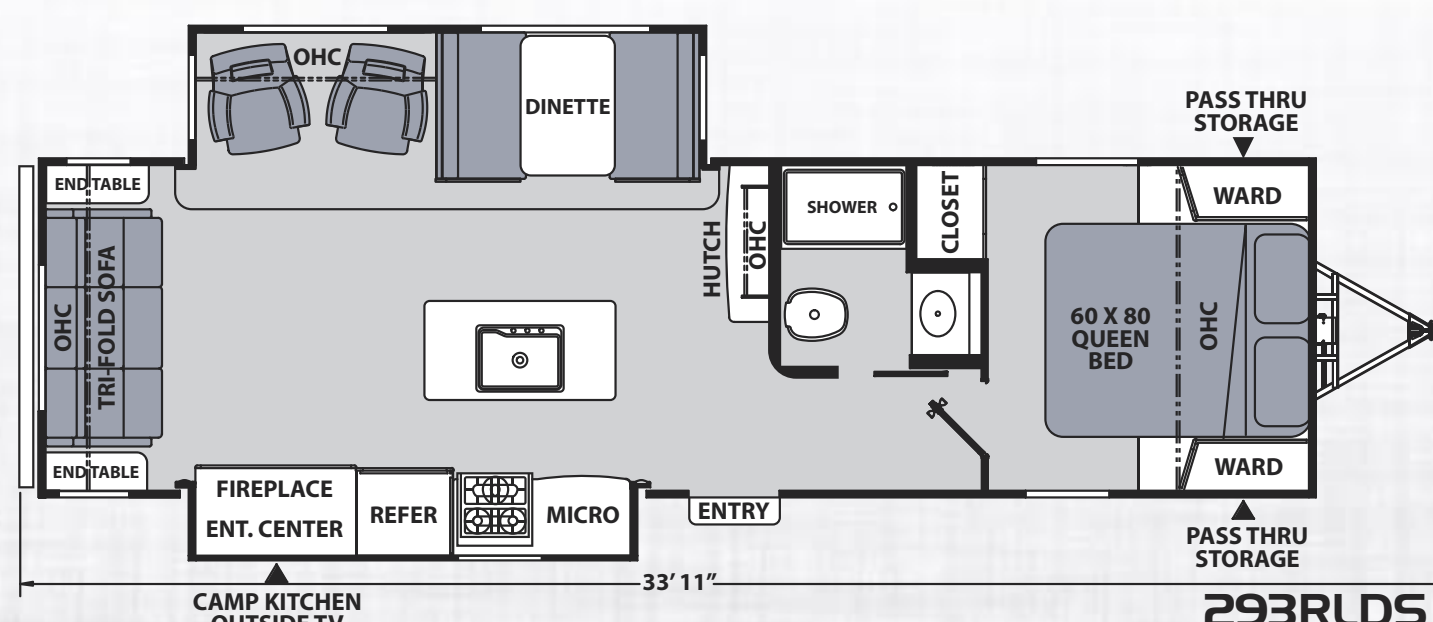
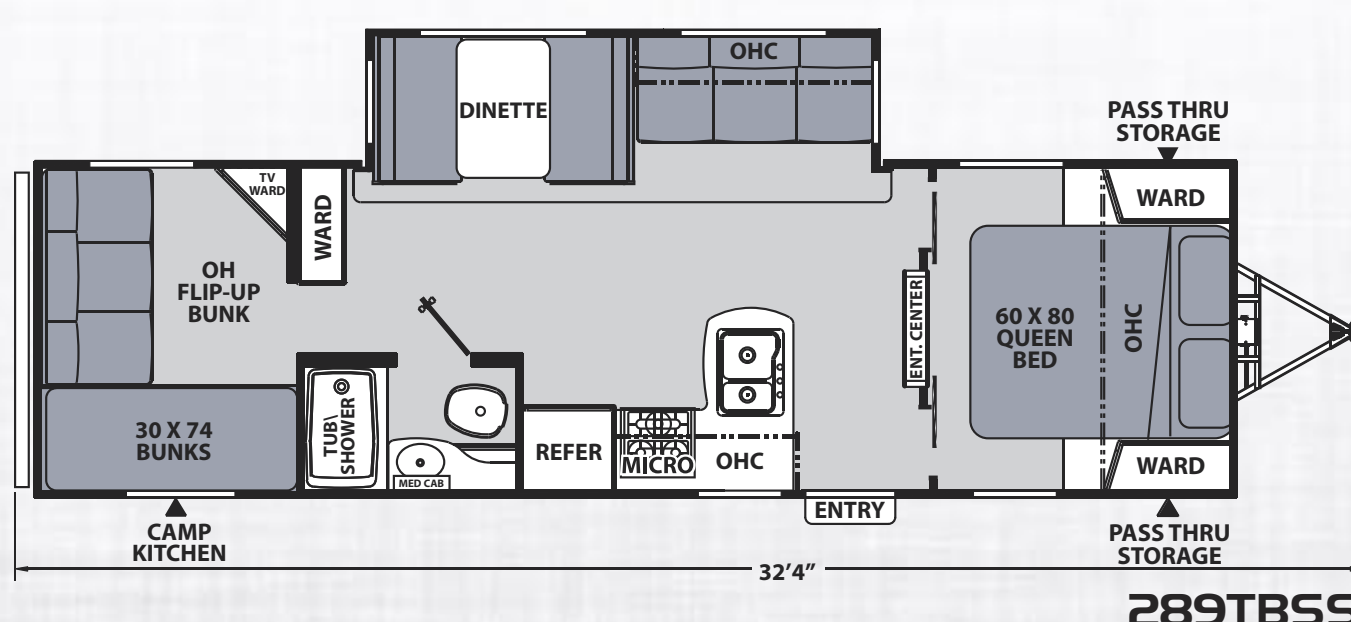
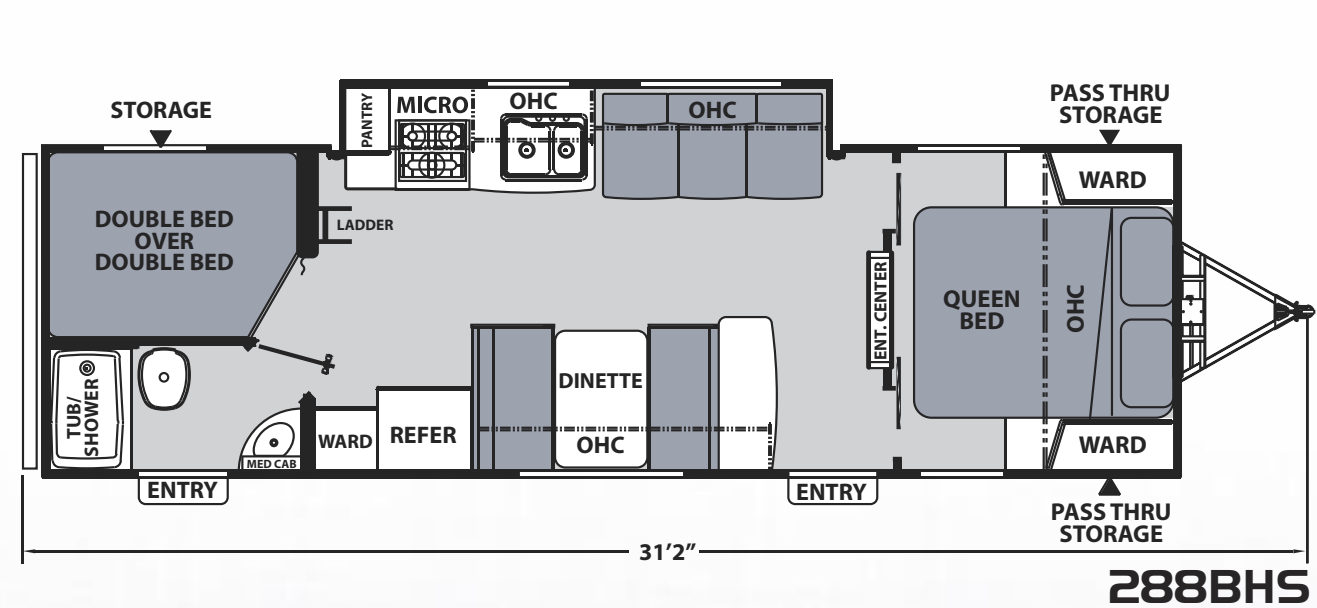
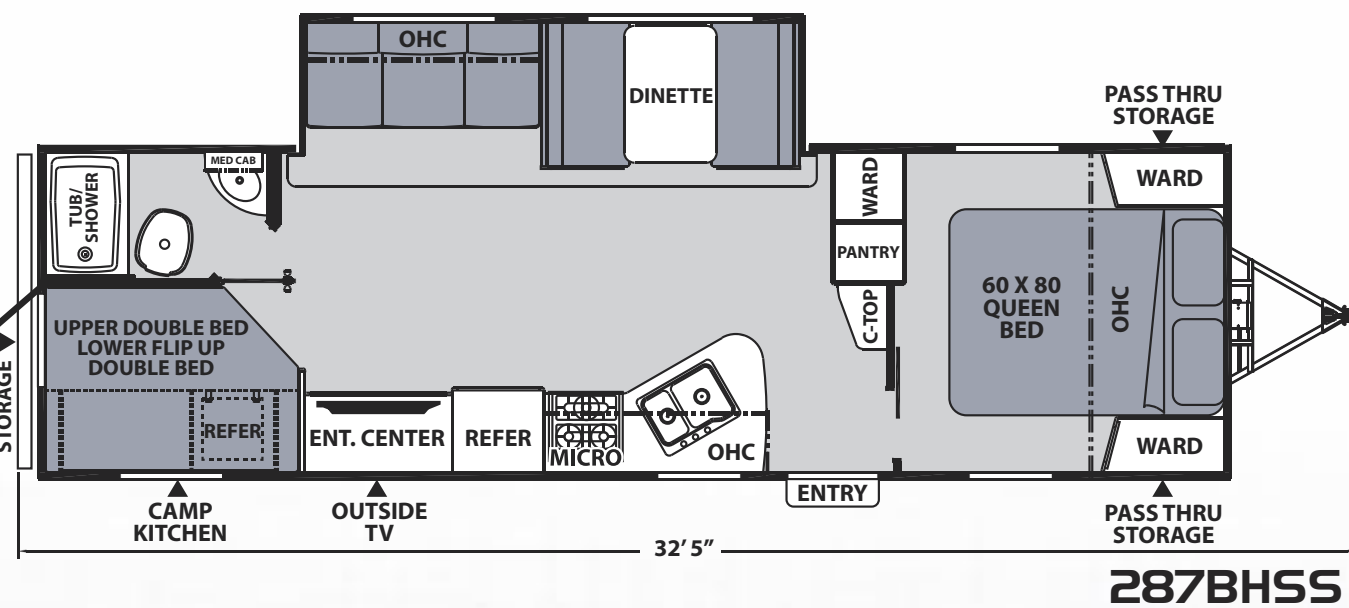
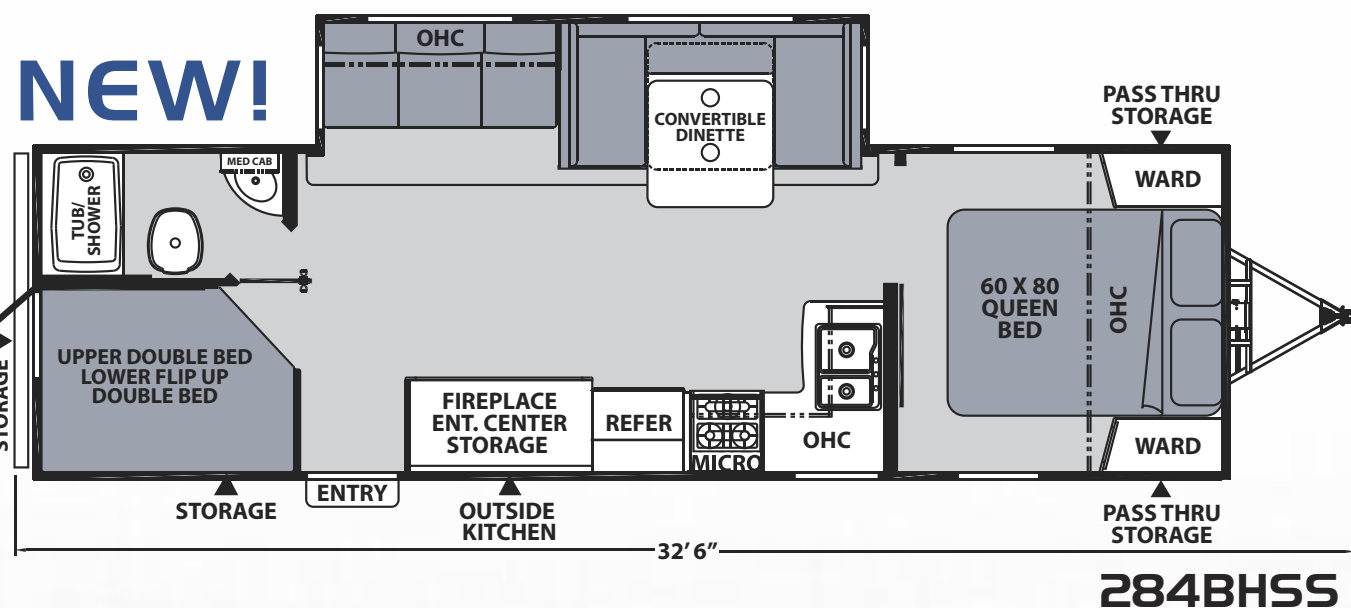
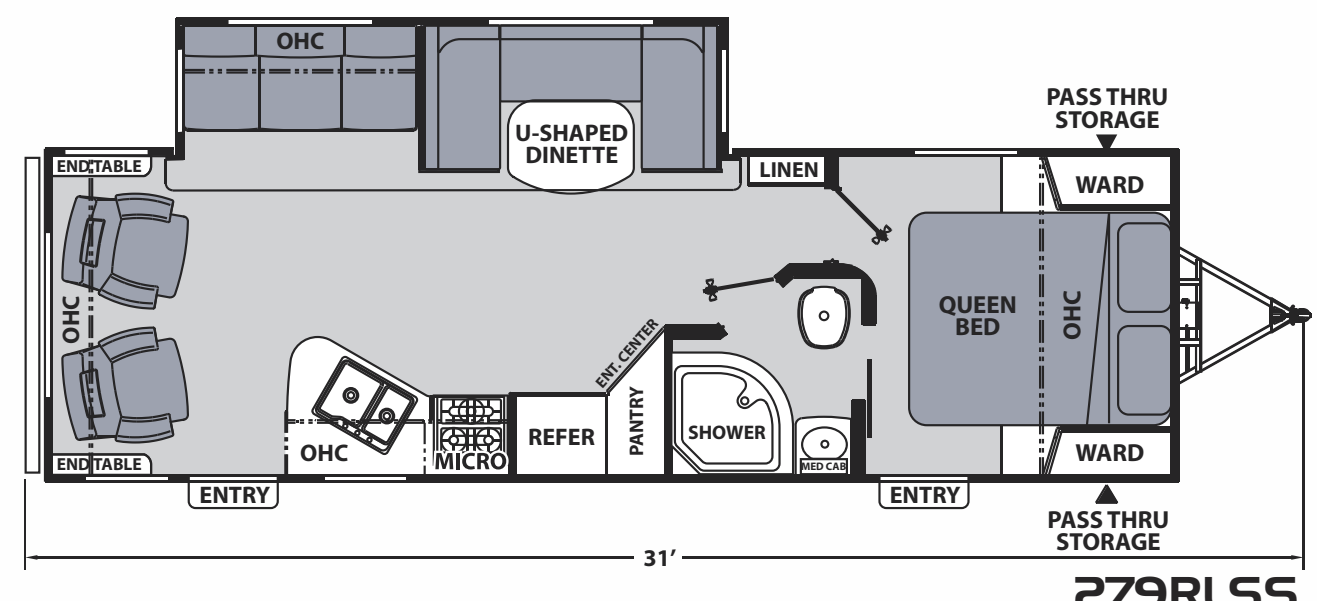
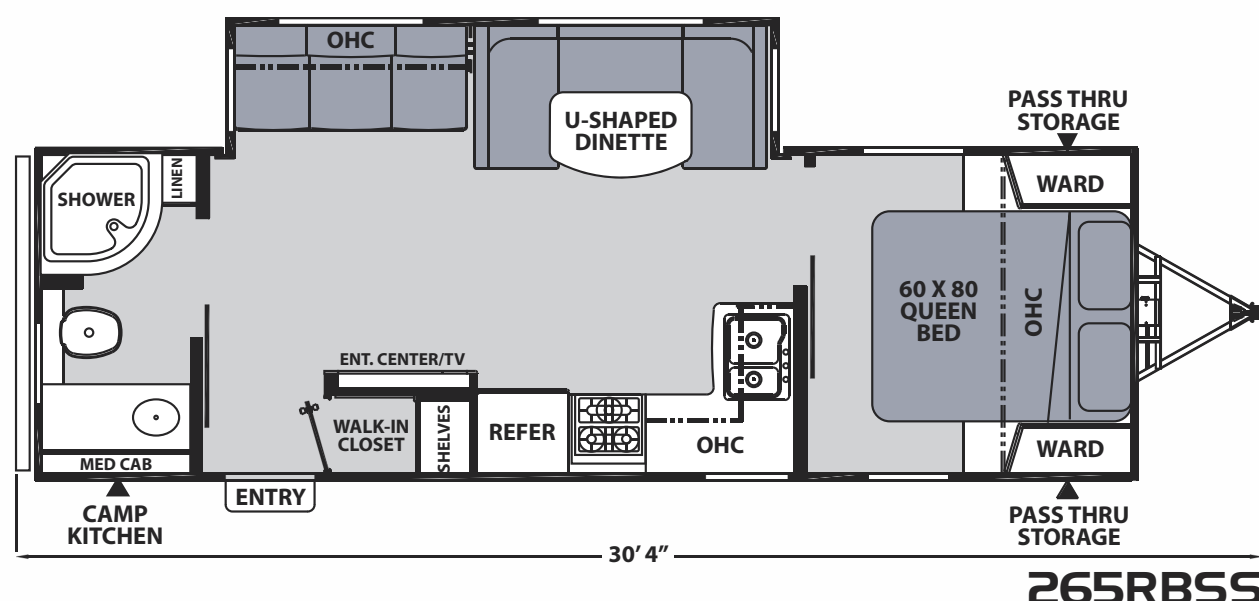
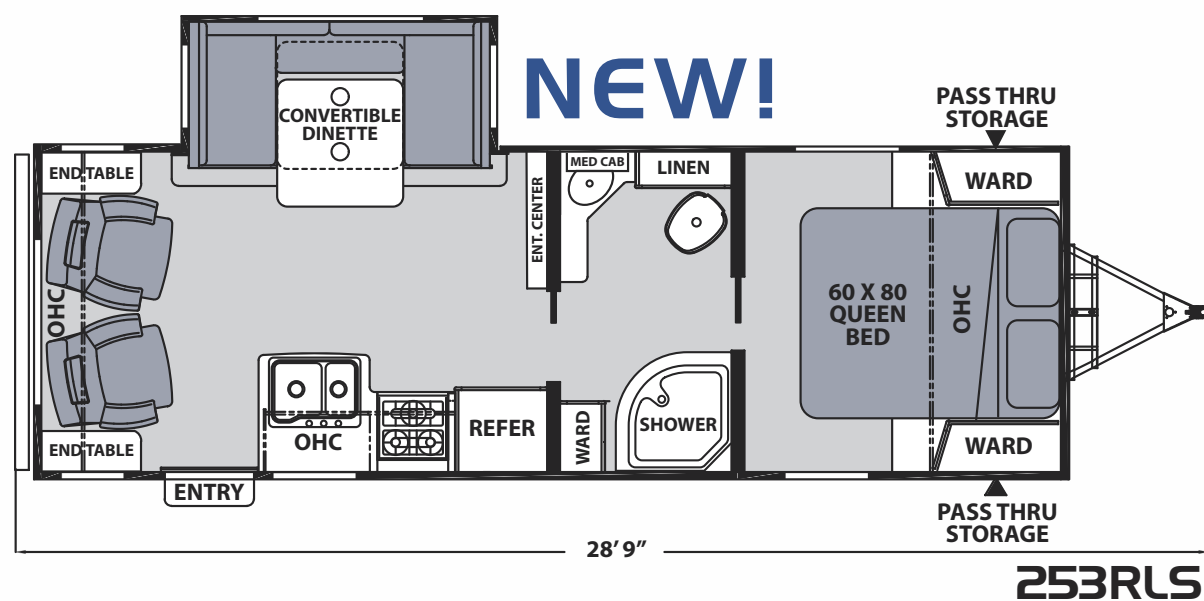
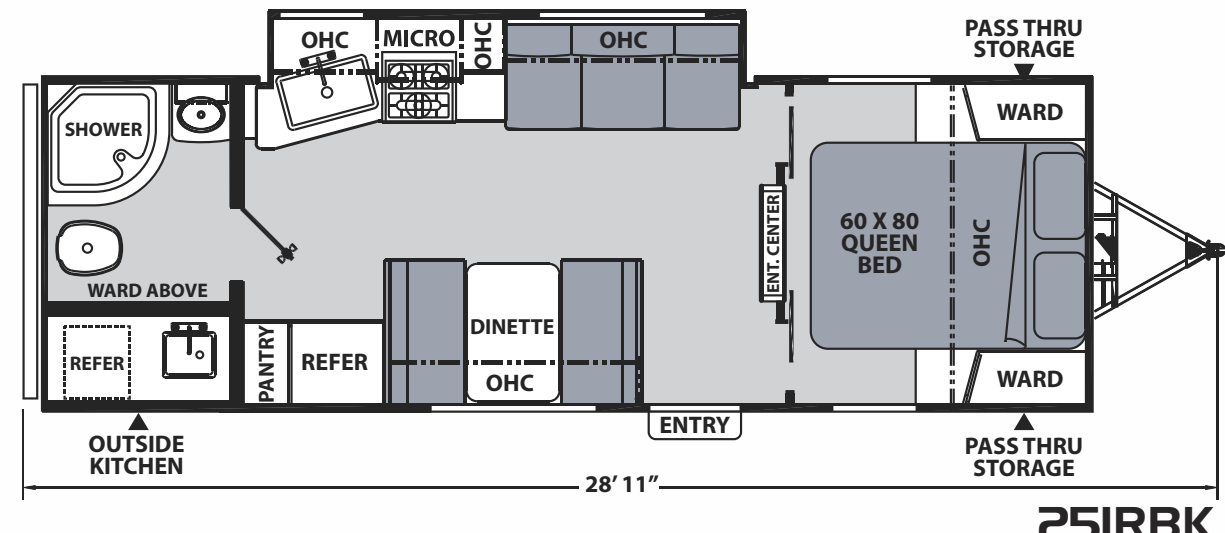
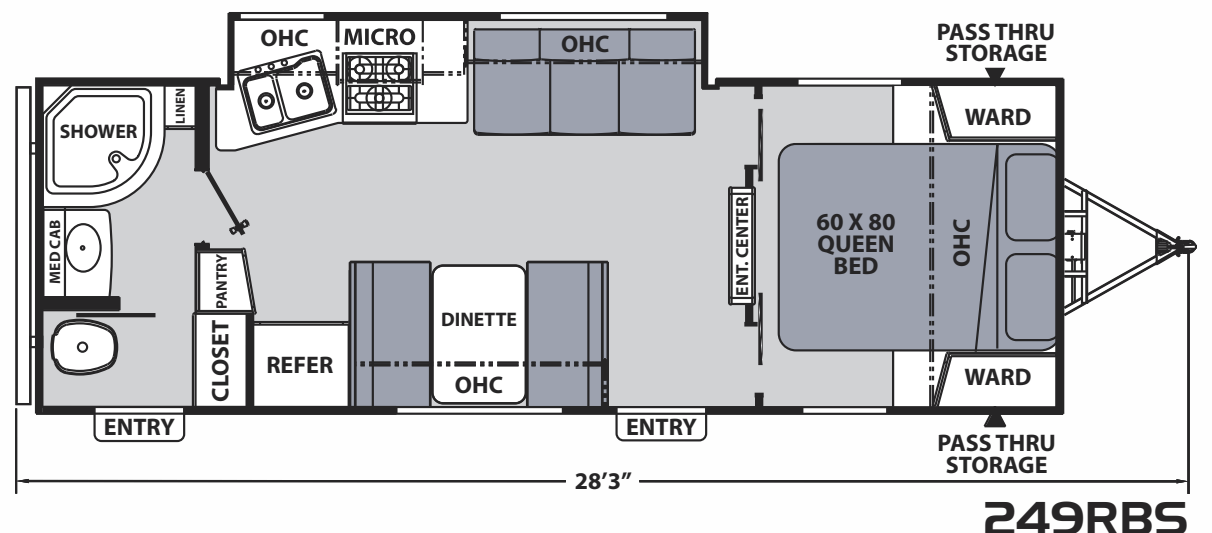
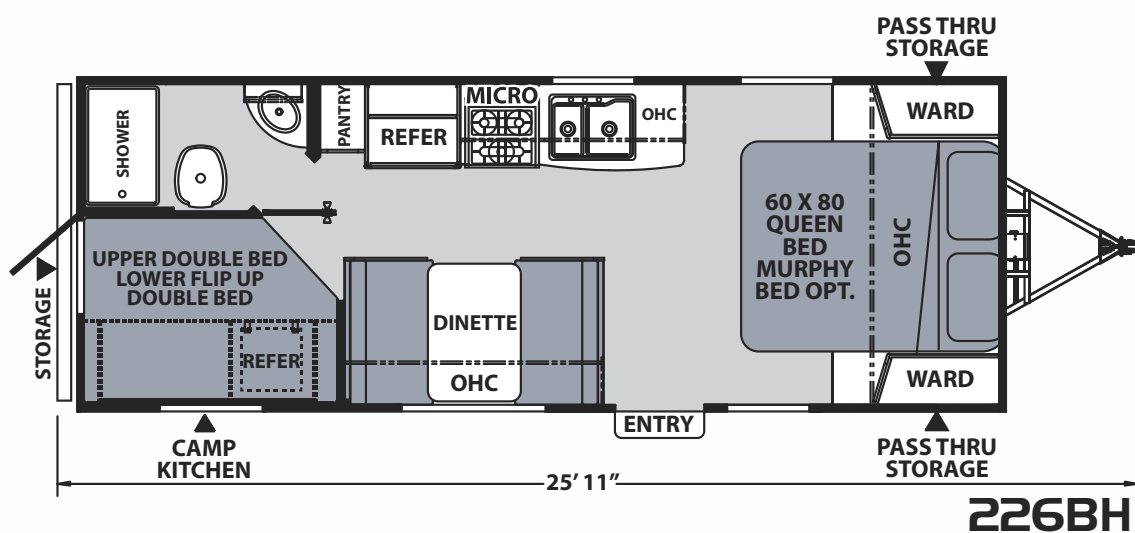

Apex 7.5' Wide	215RBK	245BHS
UVW	4,365	4,586
Hitch Weight	446	578
Carrying Capacity	2,135	1,914
GVWR	6,500	6,500
Exterior Length (Bumper to Hitch)	25' 4"	27' 6"
Exterior Height (Includes A/C)	10' 3"	10' 3"
Fresh Water Capacity (gal.)	50	50
Grey Water Capacity (gal.)	30	30
Waste Water Capacity (gal.)	30	30
Awning Length	13'	18'

Apex 8' Wide	226BH	249RBS	251RBK	253RLS	265RBSS	279RLSS	284BHSS	287BHSS	288BHS	289TBSS	293RLDS	300BHS
UVW	4,436	4,770	4,984	TBD	5,652	5,490	TBD	5,946	4,882	5,720	6,440	5,977
Hitch Weight	501	480	570	TBD	734	620	TBD	792	585	715	832	672
Carrying Capacity	2,064	2,230	2,016	TBD	1,948	2,110	TBD	1,654	2,118	1,880	1,360	1,623
GVWR	6,500	7,000	7,000	TBD	7,600	7,600	TBD	7,600	7,000	7,600	7,800	7,600
Exterior Length (Bumper to Hitch)	25' 11"	28' 3"	28' 11"	28' 9"	30' 4"	31'	32' 6"	32' 5"	31' 2"	32' 4"	33' 11"	34' 3"
Exterior Height (w/A/C)	10' 3"	10' 3"	10' 3"	10' 3"	10' 3"	10' 3"	10' 3"	10' 3"	10' 3"	10' 3"	10' 3"	10' 3"
Fresh Water Capacity (gal.)	50	50	50	50	50	50	50	50	50	50	50	50
Grey Water Capacity (gal.)	35	35	35	35	70	35	35	35	35	35	35	35
Waste Water Capacity (gal.)	35	35	35	35	35	35	35	35	35	35	35	35
Awning Length	18'	16'	16'	TBD	18'	18'	TBD	18'	16'	18'	18'	18'

Each Forest River RV is weighed at the manufacturing facility prior to shipping. A label identifying the unloaded vehicle weight of the actual unit and the cargo carrying capacity is applied to every Forest River RV prior to leaving our facilities. The load capacity of your unit is designated by weight, not by volume, so you cannot necessarily use all available space when loading your unit. All information contained in this brochure is believed to be accurate at the time of publication. However, during the model year, it may be necessary to make revisions and Forest River, Inc., reserves the right to make all such changes without notice, including prices, colors, materials, equipment and specifications as well as the addition of new models and the discontinuance of models shown in this brochure. Therefore, please consult with your Forest River dealer and confirm the existence of any materials, design or specifications that are material to your purchase decision. ©2019 Apex by Coachmen RV, a Division of Forest River, Inc., a Berkshire Hathaway company. All rights reserved. 9/19

GVWR (Gross Vehicle Weight Rating) - is the maximum permissible weight of the unit when fully loaded. It includes all weights, inclusive of all fluids, cargo, optional equipment and accessories. For safety and product performance do NOT exceed the GVWR.

GAWR (Gross Axle Weight Rating) - is the maximum permissible weight, including cargo, fluids, optional equipment and accessories that can be safely supported by a combination of all axles.

UVW (Unloaded Vehicle Weight) - is the typical weight of the unit as manufactured at the factory. It includes all weight at the unit's axle(s) and tongue or pin and LP Gas. The UVW does not include cargo, fresh potable water, additional optional equipment or dealer installed accessories.

CCC (Cargo Carrying Capacity) - is the amount of weight available for fresh potable water, cargo, additional optional equipment and accessories. CCC is equal to GVWR minus UVW. Available CCC should accommodate fresh potable water (8.3 lbs per gallon). Before filling the fresh water tank, empty the black and gray tanks to provide for more cargo capacity.

*Estimated average based on standard build optional equipment.

Lightweight • Easy to Tow • Contemporary Styling



423 N. Main Street • P.O. Box 30 • Middlebury, IN 46540
To learn more about Coachmen RV and our products and see how Coachmen is making the easy life easier, visit www.coachmenrv.com.

