

# APEX

LIGHTWEIGHT • EASY TO TOW

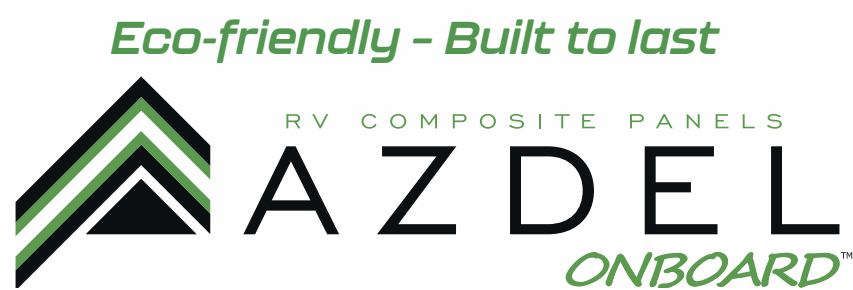

Designed for towing by today's half-ton trucks, minivans and SUVs. All units are available under 6,500 lbs. in 25' - 35' lengths.

PERFECT FOR SMALLER TOW VEHICLES



## 7-1/2' WIDE ULTRALITES

## 8' WIDE ULTRALITES

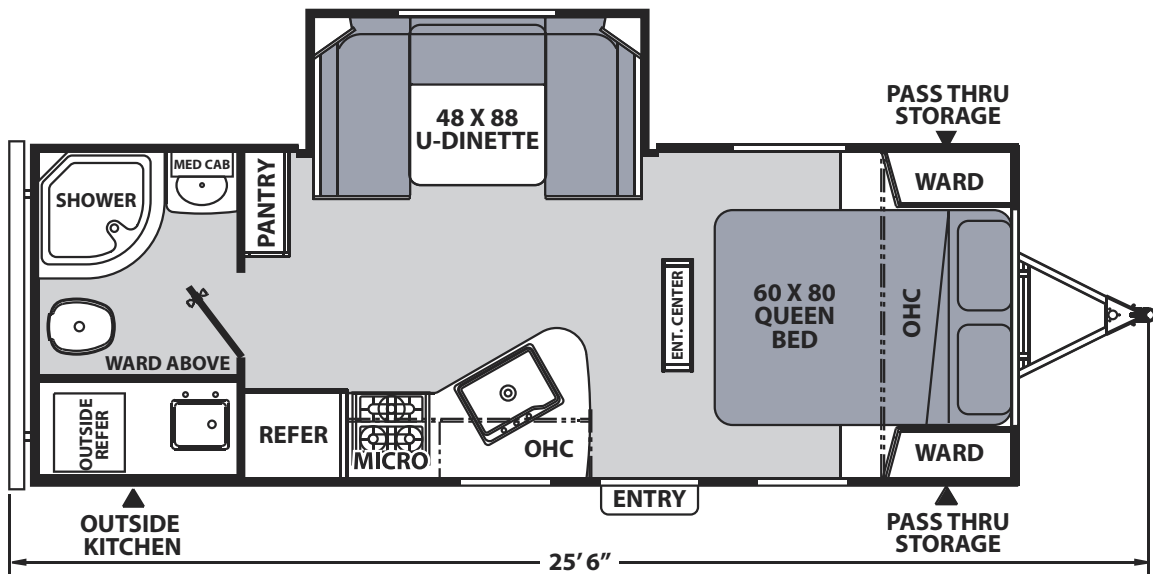

215 RBK

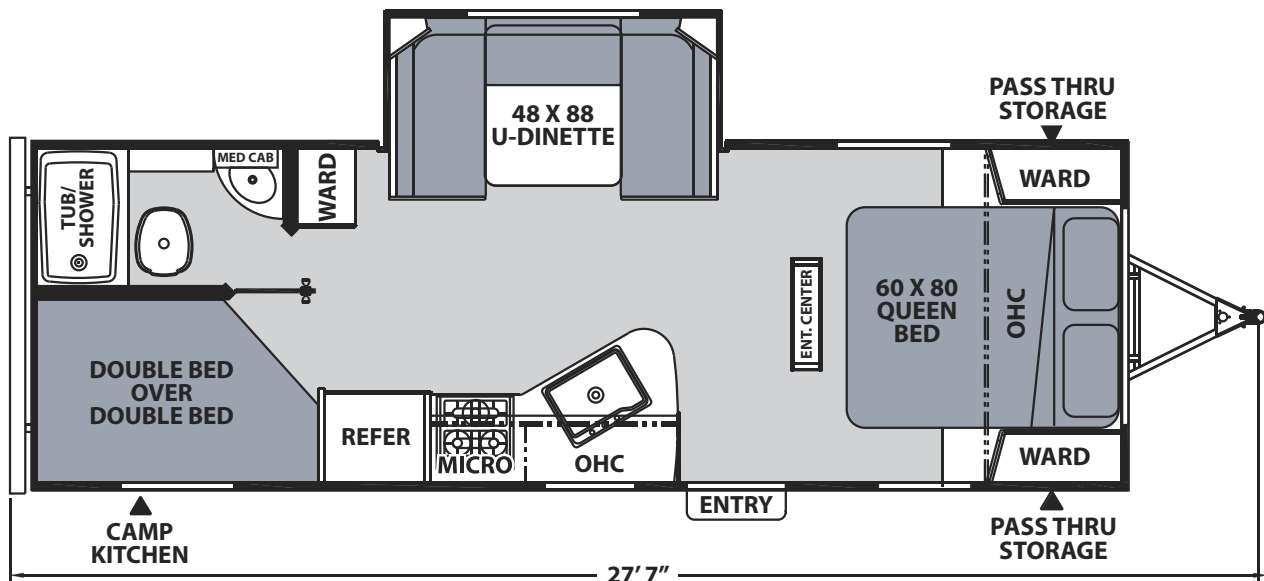

245 BHS

Apex 7.5' Wides	215 RBK	245 BHS
Hitch Weight (lbs.)	446	578
Carrying Capacity (lbs.)	2,137	1,914
UVW (lbs.)	4,363	4,584
GVWR (lbs.)	6,500	6,500
Ext. Length (Incl. Bumper to Hitch)	25' 6"	27' 7"
Ext. Height (Incl. A/C)	9' 11"	9' 10"
Int. Height (Coach)	78"	78"
Awning Length	13'	18'
Fresh Water Capacity (gal.)	50	50
Grey Water Capacity (gal.)	35	35
Waste Water Capacity (gal.)	35	35

**GVWR (Gross Vehicle Weight Rating)** - is the maximum permissible weight of the unit when fully loaded. It includes all weights, inclusive of all fluids, cargo, optional equipment and accessories. For safety and product performance do NOT exceed the GVWR.

**GAWR (Gross Axle Weight Rating)** - is the maximum permissible weight, including cargo, fluids, optional equipment and accessories that can be safely supported by a combination of all axles.

**UVW (Unloaded Vehicle Weight)\*** - is the typical weight of the unit as manufactured at the factory. It includes all weight at the unit's axle(s) and tongue or pin and LP Gas. The UVW does not include cargo, fresh potable water, additional optional equipment or dealer installed accessories.

\*Estimated average based on standard build optional equipment.

**CCC (Cargo Carrying Capacity)\*\*** - is the amount of weight available for fresh potable water, cargo, additional optional equipment and accessories. CCC is equal to GVWR minus UVW. Available CCC should accommodate fresh potable water (8.3 lbs per gallon). Before filling the fresh water tank, empty the black and grey tanks to provide for more cargo capacity.

\*\*Estimated average based on standard build optional equipment.



Double axle floor plans only.

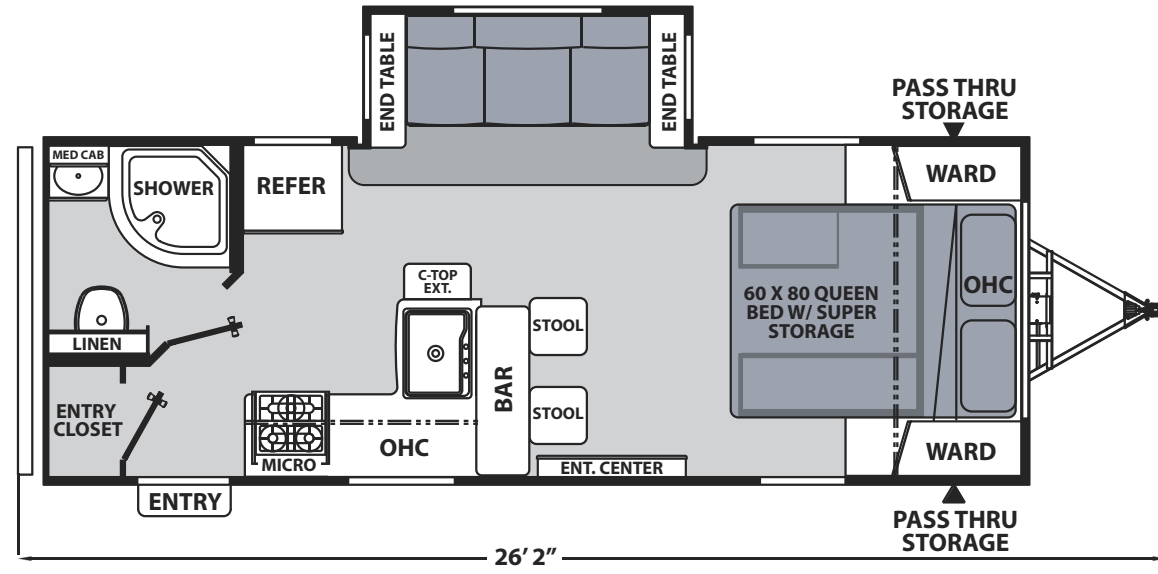

211 RBS

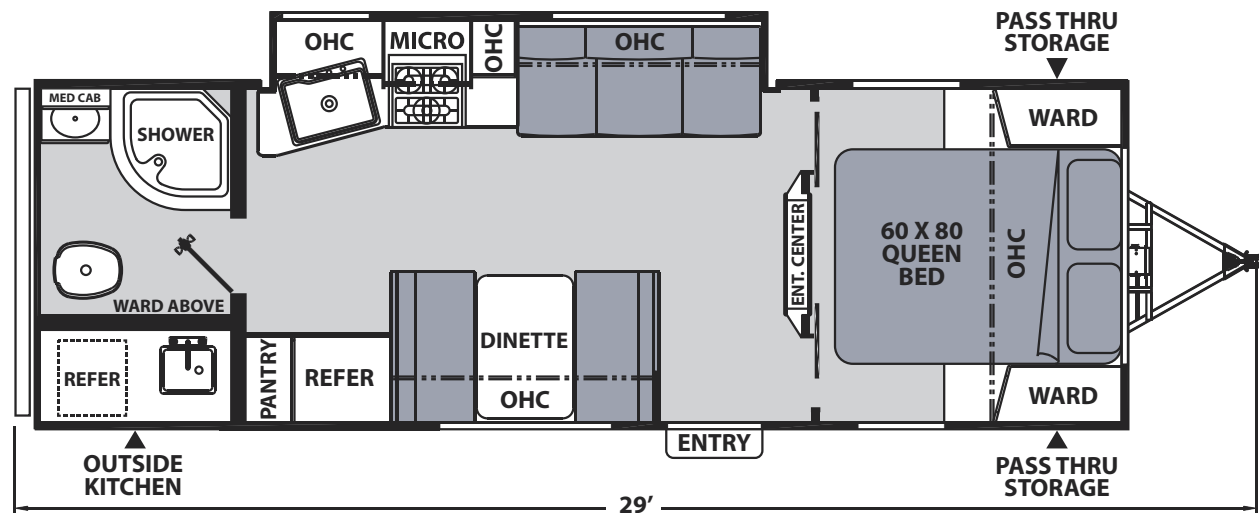

251 RBK

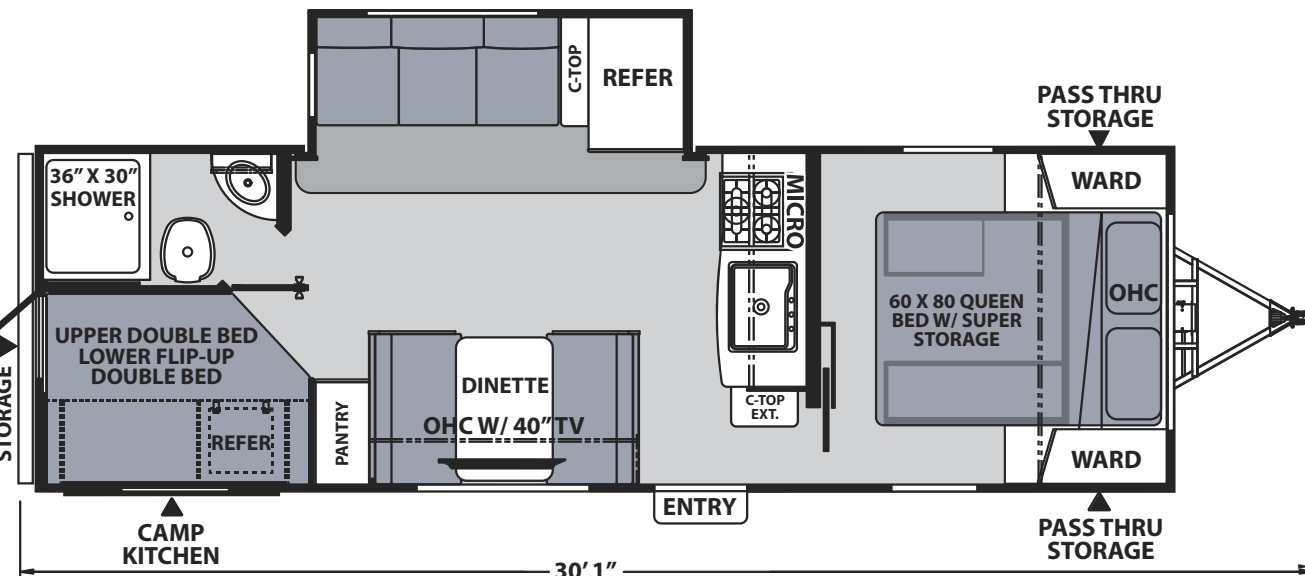

256 BHS

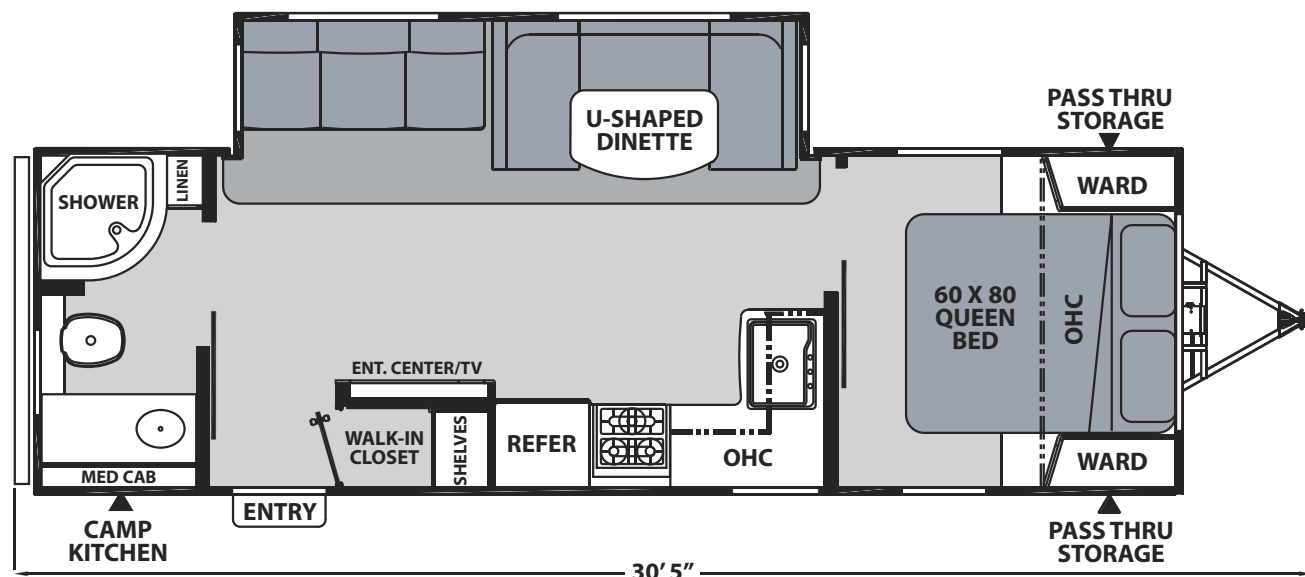

265 RBSS

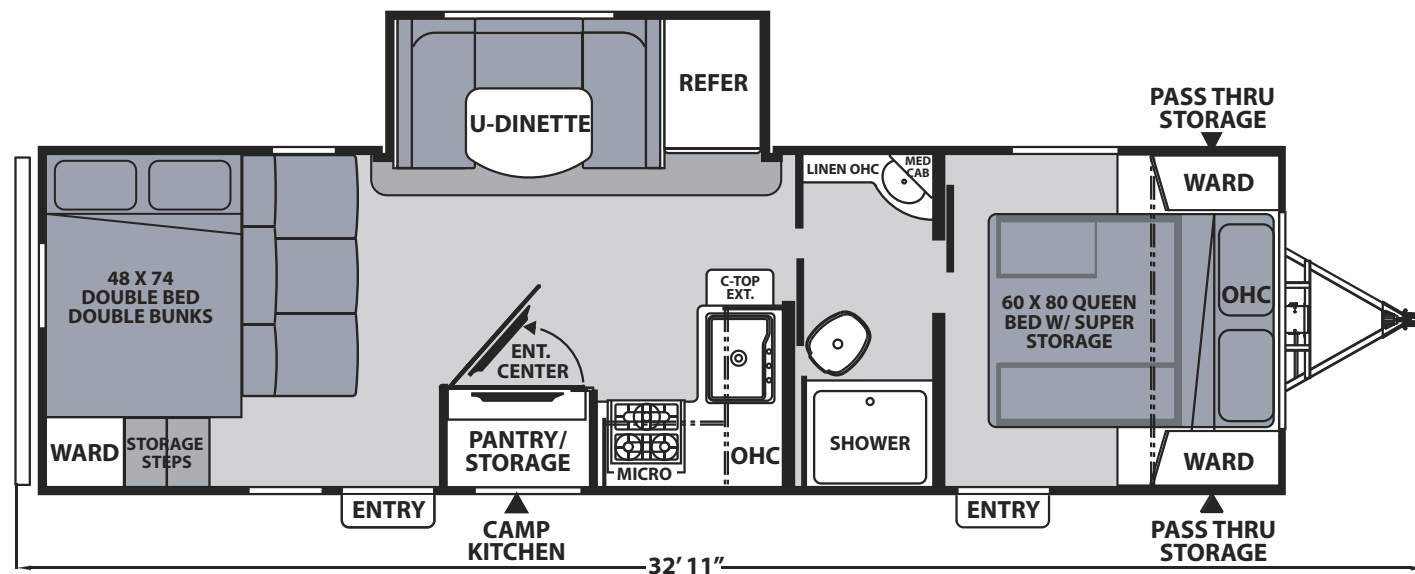

266 BHS

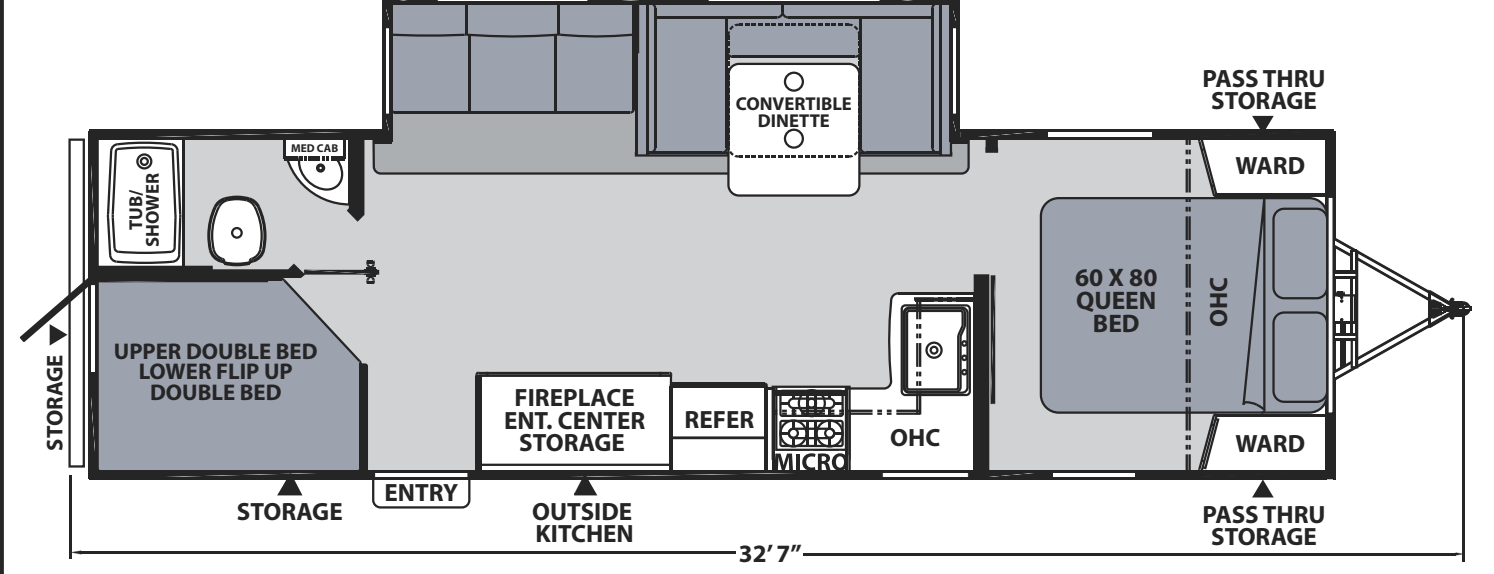

284 BHSS

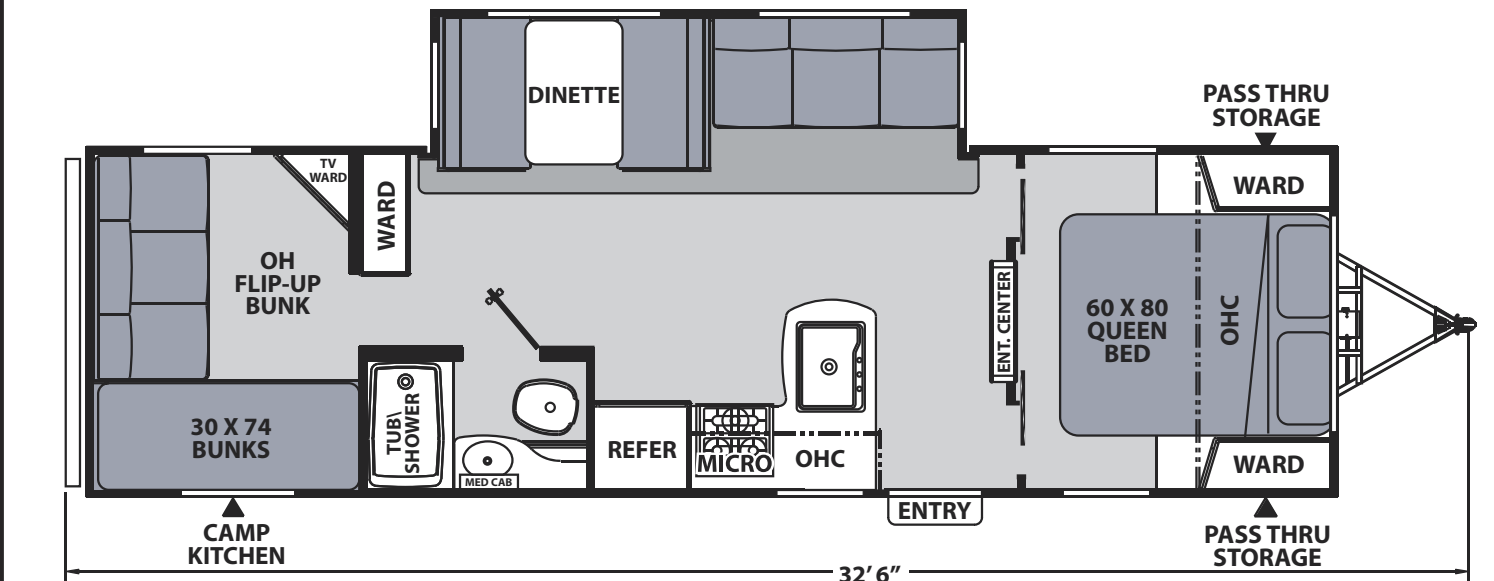

289 TBSS

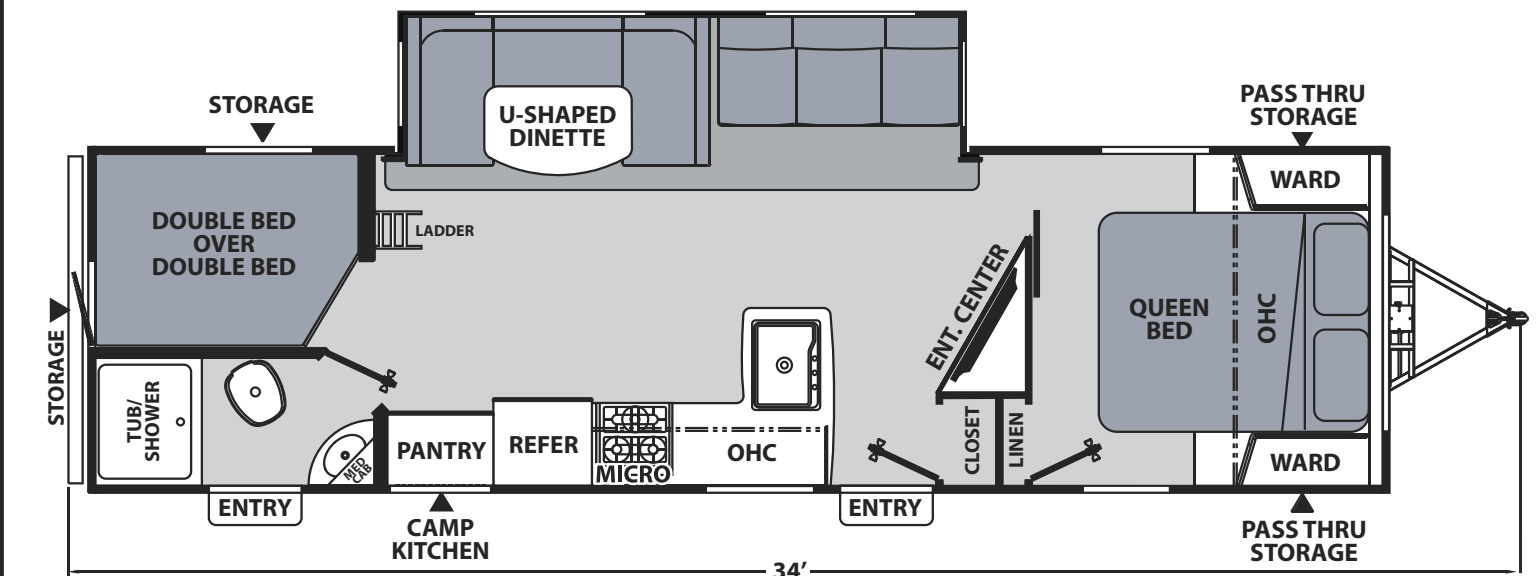

290 BHS

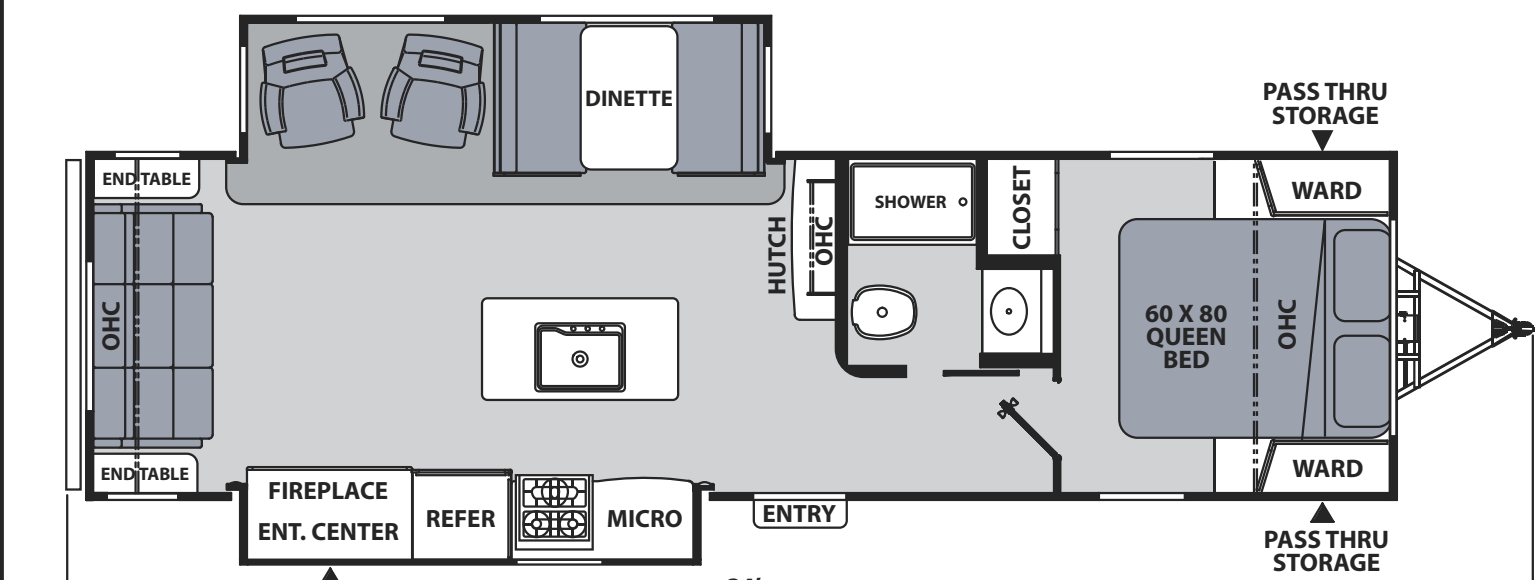

293 RLDS

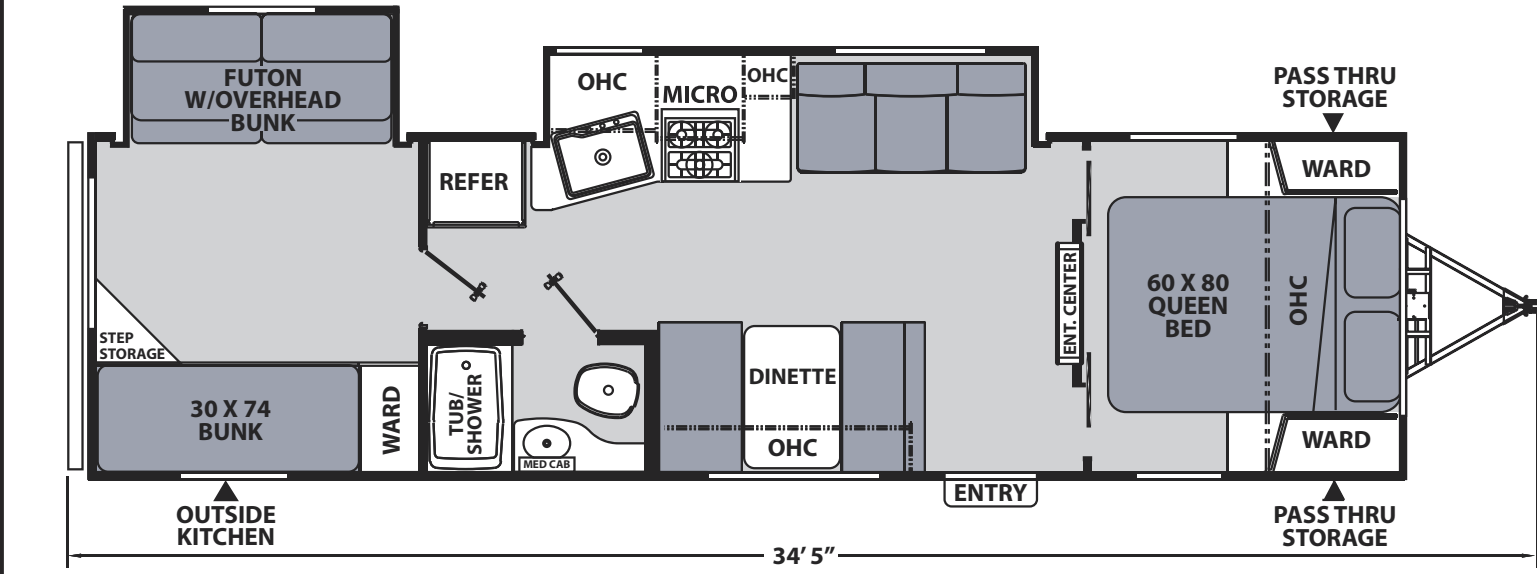

300 BHS

Apex 8' Wides	211 RBS	251 RBK	256 BHS	265 RBSS	266 BHS	284 BHSS	289 TBSS	290 BHS	293 RLDS	300 BHS
Hitch Weight (lbs.)	630	570	694	734	934	810	715	758	832	672
Carrying Capacity (lbs.)	1,938	2,016	2,128	1,948	1,520	1,578	1,882	1,432	1,360	1,625
UVW (lbs.)	5,062	4,984	5,472	5,652	6,080	6,022	5,718	6,168	6,440	5,975
GVWR (lbs.)	7,000	7,000	7,600	7,600	7,600	7,600	7,600	7,600	7,800	7,600
Ext. Length (Incl. Bumper to Hitch)	26' 2"	29'	30' 1"	30' 5"	32' 11"	32' 7"	32' 6"	34'	34'	34' 5"
Ext. Height (Incl. A/C)	10' 5"	10' 1"	10' 5"	10' 6"	10' 5"	10' 7"	10' 6"	10' 7"	10' 7"	10' 1"
Int. Height (Coach)	78"	78"	78"	78"	78"	78"	78"	78"	78"	78"
Awning Length	16'	16'	16'	18'	20'	18'	18'	20'	18'	18'
Fresh Water Capacity (gal.)	50	50	50	50	50	50	50	50	50	50
Grey Water Capacity (gal.)	35	35	70	70	35	70	35	35	70	35
Waste Water Capacity (gal.)	35	35	35	35	35	35	35	35	35	35



423 N. Main Street • P.O. Box 30 • Middlebury, IN 46540  
To learn more about Coachmen RV and our products and see how Coachmen is making the easy life easier, visit [coachmenrv.com/travel-trailers/apex-ultra-lite](http://coachmenrv.com/travel-trailers/apex-ultra-lite)



[www.ForestRiverBuyLocal.com](http://www.ForestRiverBuyLocal.com)



Each Forest River RV is weighed at the manufacturing facility prior to shipping. A label identifying the unloaded vehicle weight of the actual unit and the cargo carrying capacity is applied to every Forest River RV prior to leaving our facilities. The load capacity of your unit is designated by weight, not by volume, so you cannot necessarily use all available space when loading your unit. All information contained in this brochure is believed to be accurate at the time of publication. However, during the model year, it may be necessary to make revisions and Forest River, Inc., reserves the right to make all such changes without notice, including prices, colors, materials, equipment and specifications as well as the addition of new models and the discontinuance of models shown in this brochure. Therefore, please consult with your Forest River dealer and confirm the existence of any materials, design or specifications that are material to your purchase decision. ©2021 Apex by Coachmen RV, a Division of Forest River, Inc., a Berkshire Hathaway company. All rights reserved. 10/21