

SPORTSCOACH

# SPORTSCOACH



# A LUXURY COACH, INSIDE AND OUT.

WHEN NOT TAKING IN BREATHTAKING VIEWS FROM THE GREAT OUTDOORS, FEAST YOUR EYES ON THE REMARKABLE INTERIOR VIEWS OF THE SPORTSCOACH – THE MOST AFFORDABLE DIESEL ON THE MARKET.



Whether you're preparing a meal or watching your favorite sporting event, Sportscoach has it all. From its tastefully appointed kitchen to the exterior smart TV, you'll want to show it off.

New cockpit dash console includes LED lighting around cupholders and gauges for easier nighttime navigation.



With a 360HP ISB Cummins rear diesel engine and a 6-speed Allison 3,000 MH automatic transmission, Sportscoach gets 800 lbs./ft. of torque and has a 10,000 pound towing capacity.

Storage is plentiful in Sportscoach, including a pass-through full basement that's ideal for stowing oversized gear without compromising living space.

Sportscoach comes fully-equipped with an outdoor entertainment system, including an exterior smart TV.

The generator is mounted on a slide system for ease of maintenance.



### INTERIOR DÉCOR COLOR SELECTIONS



Chiffon



Sandcastle

### INTERIOR WOOD COLOR SELECTIONS



Cloud



Shadow

### EXTERIOR COLOR OPTIONS



Full Body Paint - Crater Lake



Full Body Paint - Glacier Bay



Full Body Paint - Joshua Tree



Full Body Paint - Redwood



Photography features the Sportscoach 411TS floorplan with Sandcastle interior and Cloud cabinetry.



Sportscoach's over-sized dinette is comfortable and spacious with a smart TV.

The main bathroom is both appealingly designed and easy to clean. Built with a medicine cabinet and vessel sink (where applicable).

Strip lighting integrated into the ceiling provides more light and a cleaner ceiling.

New square windows provide more airflow and a refined look. Integrated day/night shades create less road noise than traditional blinds.



In the bedroom you'll find a king mattress with an elegant designer headboard, spacious wardrobe, generous dresser and a smart TV.

The Coach-Pap™ Station allows for storage of CPAP machines and other electronics, located in the cabinet above the bed.



The master bathroom is beautifully appointed. There's room for two with double vessel sinks and dual medicine cabinets, it also features a glass shower door with skylight. (411TS)

There's even room for the kids to sleep over with the drop-down cabover bunk.

Sportscoach RR includes two floorplan options, so you'll have no trouble choosing the one that suits you perfectly.

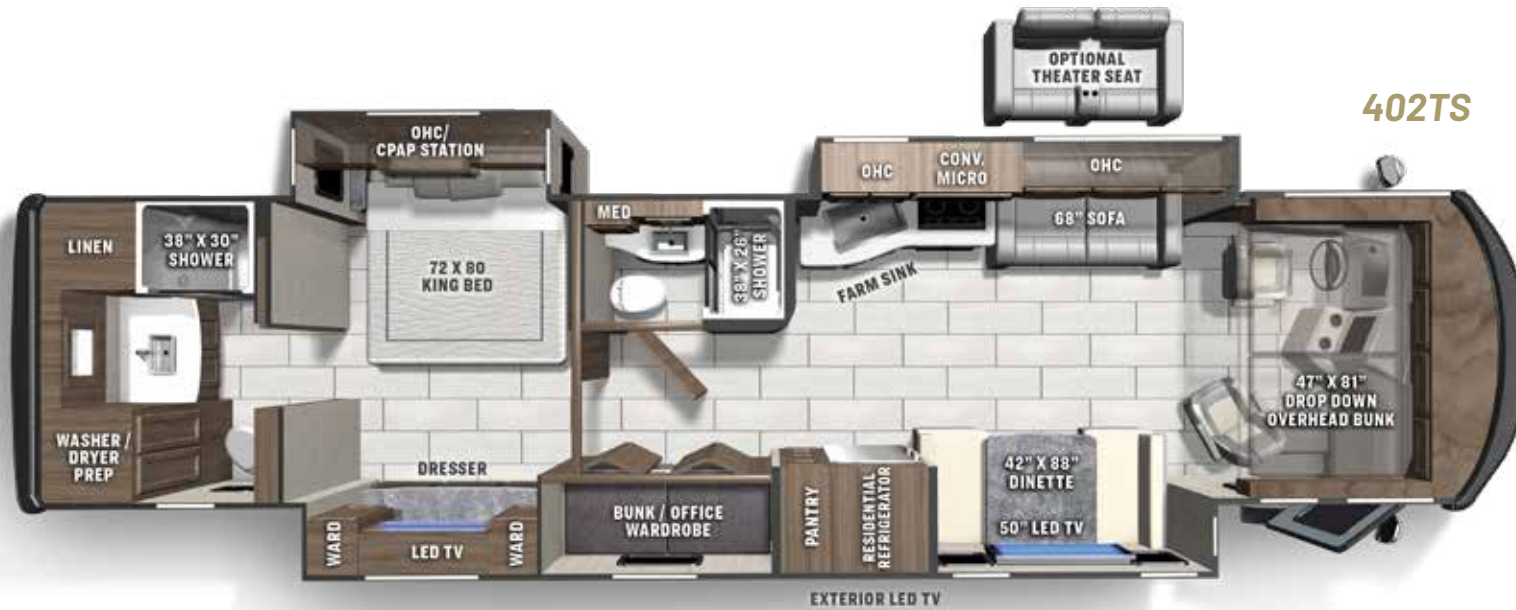

# FLOORPLANS

## SPORTSCOACH RR SPECIFICATIONS

CLASS A DIESEL	402TS	411TS
CUMMINS ISB 6.7L ENGINE	360 HP@2600 RPM	360 HP@2600 RPM
ALLISON TRANSMISSION	3000MH	3000MH
WHEEL BASE	266"	266"
GVWR	32,000 lbs	32,000 lbs
GCWR	42,000 lbs	42,000 lbs
GAWR FRONT	12,000 lbs	12,000 lbs
GAWR REAR	20,000 lbs	20,000 lbs
FUEL CAPACITY	100 gal	100 gal
LP GAS CAPACITY	20 gal	20 gal
FURNACE (BTUs)	(2)20,000	(2)20,000
EXTERIOR LENGTH (w/o Ladder)	41' 1"	41' 1"
EXTERIOR HEIGHT (w/A/C)	12' 10"	12' 10"
EXTERIOR WIDTH	102"	102"
FRESH WATER	89 gal	89 gal
GREY WATER	104 gal	52 gal
BLACK WATER	52 gal	52 gal
WATER HEATER	10 gal	10 gal
AWNING SIZE	18'	18'
TOW HITCH	10,000 lbs	10,000 lbs

**GVWR (Gross Vehicle Weight Rating)** is the maximum permissible weight of the unit when fully loaded. It includes all weights, inclusive of all fluids, occupants, cargo, optional equipment and accessories. For safety and product performance do NOT exceed the GVWR.

**GCWR (Gross Combined Weight Rating)** is the maximum permissible loaded weight of your motor home and any towed trailer or towed vehicle. Actual GCWR of this vehicle may be limited by the sum of the GVWR and the installed hitch receiver maximum capacity rating; see hitch rating label for detail.

**GAWR (Gross Axle Weight Rating)** is the maximum permissible weight, including cargo, fluids, optional equipment and accessories that can be safely supported by each axle.

**UVW (Unloaded Vehicle Weight)\*** is the typical weight of the unit as manufactured at the factory. It includes all weight at the unit's axle(s), including full fuel, all fluids and LP Gas. The UVW does not include cargo, fresh potable water, additional optional equipment or dealer installed accessories.

\*Estimated Average based on standard build optional equipment.

**CCC (Cargo Carrying Capacity)\*\*** is the amount of weight available for fresh potable water, cargo, passengers, additional optional equipment and accessories. CCC is equal to GVWR minus UVW. Available CCC should accommodate fresh potable water (8.3 lbs per gallon). Before filling the fresh water tank, empty the black and gray tanks to provide for more cargo capacity.

\*\* Estimated average based on standard build optional equipment

Each Coachmen motorhome is weighed at the manufacturing facility prior to shipping. A label identifying the unloaded vehicle weight of the actual unit and the cargo carrying capacity is applied to every Coachmen motorhome prior to leaving our facilities.

The load capacity of your unit is designated by weight, not by volume, so you cannot necessarily use all available space when loading your unit.

Actual towing capacity is dependent upon your particular loading and towing circumstances, which includes the GVWR, GAWR and GCWR as well as adequate trailer brakes. Please refer to the Operator's Manual of your vehicle for further towing information.

All information contained in this brochure is believed to be accurate at the time of publication. However, during the model year, it may be necessary to make revisions and Coachmen reserves the right to make all such changes without notice, including prices, colors, materials, equipment and specifications as well as the addition of new models and the discontinuance of models shown in this brochure. Therefore, please consult with your Coachmen dealer and confirm the existence of any materials, design or specifications that are material to your purchase decision.

## STANDARD FEATURES

### INTERIOR APPOINTMENTS

Flat Panel Hardwood Cabinet Doors Throughout  
Self Closing Ball Bearing Drawer Guides Throughout  
Solid Surface Countertop in Galley  
Manual Side Shades in Driver - Passenger Area  
Deluxe Driver/Passenger Seat with 3-Point Seat Belt  
Day/Night Shades Throughout  
Theater Seating (411TS)  
Visionary Sofa Hide-A-Bed  
Dinette  
Storage Drawers Under Booth Dinette  
Power Front Solar Privacy Shade

### INTERIOR EQUIPMENT

50" Smart TV Coach (402TS)  
65" Smart TV Coach (411TS)  
King Jack TV - Radio Antenna  
Pre-Wired for Satellite Dish and Blu-Ray Players  
10" Touch Screen Radio AM/FM Radio  
with Bluetooth Apple CarPlay and  
Android Auto Link Enabled

### GALLEY

30" Stainless Steel OTR Microwave  
Stainless Steel Residential Refrigerator  
Kitchen Backsplash  
Fantastic Power Ceiling Vent  
Solid Surface Sink Covers  
Stainless Steel Farmhouse Sink  
Pop-Up Recept with USB Ports

### BATH AND WATER

Whole Coach Water Filter  
Single Pedal Porcelain Toilet with Sprayer  
Power Bath Vent  
Skylight Over Shower  
Winterization INLET at Termination  
Compartment  
Water Pump Switch at Termination  
Black Tank Flush System  
Demand Water Pump  
10-Gallon Gas/Electric Water Heater  
Systems Monitor Panel  
Washer/Dryer Prep

### SLEEPING

King Bed 72 X 80  
Upgraded Mattress  
Bedspread, Pillows with Shams  
Residential Style Headboard  
32" Smart TV Bedroom  
Front Drop-Down-Bunk  
USB Ports on Both Sides of Bed  
C-PAP Shelf Cabinet  
Bunk/Office/Wardrobe Room (402TS)

### ELECTRICAL/HEATING/AC

50-Amp Power Cord  
GFCI Circuit  
Outside Receptacle (DS)  
Emergency Start Switch  
Coach and Chassis Battery Disconnect  
Auxiliary Batteries (4)  
Exterior LED Strip Patio Light  
100W Solar Panel with Controller  
(Aftermarket Upgradeable to 300W)  
(2) 20,000 BTU E.I. Furnace  
15,000 BTU A/C with Heat Pump Front  
15,000 BTU A/C with Heat Pump Rear  
20-Gallon LP Tank  
8.0 KW Diesel Generator  
2000W Pure Sine Wave Inverter  
with 80-Amp Converter  
Automatic Transfer Switch  
Exterior Cable TV Jack and Tailgater  
Satellite Jack  
LED Interior Lighting  
Auto Generator Start  
Charging Station for Electronic Devices

### AUTOMOTIVE/EXTERIOR

Raised Rail Freightliner Vault Chassis  
Chassis Air Suspension and Air Brakes  
360 HP ISB Cummins Rear Diesel Engine,  
800 lbs./ft. Torque  
6-Speed Allison 3000MH Automatic  
Transmission  
High Definition Back Up and Side Cameras  
Fully Automatic Leveling Jacks  
Defroster Fans  
Cruise Control  
Manual Air Dump  
Intermittent Wipers  
Dash Air Conditioning  
Frameless Tinted Windows with Safety Glass  
Exterior Mirrors with Heat and Remote  
Auxiliary Driving Lights  
Fuel Fills, Both Sides  
Auxiliary Air Supply Hook-Ups  
22.5 Radial Tires  
Power Step Cover  
Power Entrance Steps-Double  
Deluxe Radius Entrance Door  
with Dead Bolt Lock  
Front and Rear Fiberglass Caps  
Air Horn  
High Gloss Gelcoat Sidewalls  
(with Azdel™ Superlite Composite)  
Aluminum Side Swing Compartment Doors  
10,000 lb. Towing Hitch with 7-Way Plug  
Power Patio Awning  
Aluminum Rims  
Power Entry Door Awning  
Slide-Out Awnings  
Pass Through Basement Storage  
Full Body Paint  
Fire Extinguisher  
LP Leak Alarm  
Smoke Detector  
Carbon Monoxide Detector  
Outside Entertainment Center with TV  
Interior and Exterior Assist Handles  
Exterior Propane Hook-Up

## OPTIONAL FEATURES

### INTERIOR COLOR SELECTIONS

Chiffon  
Sandcastle

### INTERIOR WOOD COLOR SELECTIONS

Cloud  
Shadow

### EXTERIOR COLOR SELECTIONS

Full Body Paint  
• Crater Lake  
• Glacier Bay  
• Joshua Tree  
• Redwood

### OPTIONAL FEATURES

Slide-Out Storage Tray  
Power Theatre Seating  
Washer / Dryer  
Dual Pane Windows  
In-Motion Satellite Dish  
Power Skylight (411TS)  
Diamond Shield Paint Protection -  
(Required with Full Paint)  
CSA Up-Fit  
CD-MVSA (Canadian Motor Vehicle Safety Act)<sup>1</sup>  
Double Clear Coat (Required)

#### Notes:

<sup>1</sup>Mandatory For All Canadian Provinces



# THE COACHMEN ADVANTAGE

What is the Coachmen advantage? It's the collection of unique features offered in a Coachmen motorhome to ensure a smoother ride, a better camping experience, and a motorhome that will last for years.

## 1. NOBLE SELECT™

Protected by a three-year warranty, these sidewalls have a high-gloss gelcoat finish to prevent fading. They are also 20% lighter than wood substrate sidewalls, provide more occupant cargo carrying capacity, and offer three times the insulation against extreme climates.

## 2. AZDEL™ COMPOSITE

Most manufacturers use wood sidewalls that can expand, swell, and eventually mold. We use Azdel. It's impervious to water, won't rot or mold, and, with less than a 1% chance of delaminating, it ensures the long-term integrity of the sidewalls.

## 3. REINFORCED LAMINATION

We vacuum bond and pinch roll every sidewall, floor, and roof, then perform a pull adhesion test. Most manufacturers just do one process or the other, but by doing both we improve the strength and longevity of the sidewalls.

## 4. FOREFRONT OF TECHNOLOGY

We offer the latest in technology by pairing electronics with smart phones. A safer and larger viewing area is achieved when dual-mirroring your smart phone GPS to the 10" Axxera dash radio and backup system.

## 5. SIGHT RITE DASH™

Our dashes are angled 20 degrees forward. This increases the line of sight for the driver, and offers the best road visibility on the market.

## 6. EVEN COOL DUCT™

Our patented duct system evenly disperses air through the whole coach. And we use Amaco ducting instead of Styrofoam because it's antimicrobial, preventing the growth of bacteria and ensuring a cool, clean coach in even scorching heat.

## 7. DIGITAL OWNER'S MANUAL

Our owner's manuals are easy to access through the Coachmen website or our free app. Supplemented with videos, PowerPoints, and more, it's got all you need to know about your coach.



## SCAN HERE

To see available  
Standards, Options  
and Features!



Sportscoach RV, a Division of Forest River, Inc.,  
A Berkshire Hathaway Company

423 N. Main St., P.O. Box 30, Middlebury, IN 46540

To learn more about Sportscoach RV and our products and see how Sportscoach is making the easy life easier, visit [www.coachmenrv.com](http://www.coachmenrv.com)

©Copyright 2023 Sportscoach RV a Division of Forest River Inc. - All Rights Reserved.

10/23

## CUSTOMER SATISFACTION



[www.ForestRiverBuyLocal.com](http://www.ForestRiverBuyLocal.com)



COACHMEN OWNERS ASSOCIATION

## FREE MEMBERSHIP

[www.coachmenowners.com](http://www.coachmenowners.com)



## 24/7 EMERGENCY ROADSIDE ASSISTANCE WITH VEHICLE PURCHASE\*

TOWING  
JUMP-STARTS  
TIRE CHANGES  
FLUID DELIVERY  
LOCKOUT  
SERVICE

WINCH-OUT  
MOBILE MECHANIC  
TECHNICAL  
SUPPORT  
DEALER LOCATOR  
SERVICES



\*VALID FOR 1 YEAR FROM DATE OF PURCHASE



**Learn More**  
Scan this barcode using  
a QR Reader on your  
smart phone to learn  
more about Forest River.



A Berkshire Hathaway company.